



## SUPPLY ONLY FITTING GUIDE

FAMILY OWNED WITH FAMILY VALUES

# Introduction

We would like to extend our heartfelt gratitude for entrusting us with the opportunity to supply a new kitchen for your home. We understand that the installation of a new kitchen is not just a practical endeavour, but also a significant part of creating a warm and loving environment for your family.

At The Kitchen Depot we believe that a kitchen is more than just a space for cooking. It is a place where memories are made, meals are shared, and bonds are strengthened. That’s why we take great pride in providing kitchens that are custom-made to fit your unique design.

We understand that the installation process can be overwhelming, and we want to ensure that it is a smooth and enjoyable experience for you and your family. To facilitate this, we kindly request that you introduce your chosen installation team to us before they begin their work. This will allow us to establish a personal connection, address any concerns they may have, and ensure that they have a clear understanding of your vision for your new kitchen.

In order to support you and your installation team throughout this journey, we have created a comprehensive Supply Only Guide. This guide not only includes fitting instructions and important information but also embodies our own “Installation Code of Practice.” Our aim is to provide your installation team with all the resources they need to create a kitchen that reflects your family’s need and meets the highest standards of craftsmanship.

We kindly ask that you share this guide with your installation team before they commence their work. By doing so, we can work hand in hand to create a kitchen that not only meets your practical needs but also brings warmth and joy to your family’s daily life.

Thank you once again for choosing The Kitchen Depot. We are dedicated to providing exceptional service and ensuring that your kitchen installation journey is filled with care and professionalism. Should you have any further questions or require additional assistance, please do not hesitate to reach out to us. We are here to support you every step of the way and look forward to helping you create a kitchen that will be the heart of your home.

# CONTENTS

**PART 1: WORKING WITH THE KITCHEN DEPOT**

Our Code Of Practice..... 5

Supply Only Service Agreement..... 6

Reading a Kitchen Depot Plan ..... 6

**PART 2: OUR PRODUCTS**

Construction & Benefits: Base & Wall Units..... 10

Corner Units: L Corner Base & Incline Corner ..... 13

Cabinet Features, AFF Setup & Open Units ..... 15

Hinges ..... 16

Drawers..... 19

Hafele Drawer Boxes ..... 20

Hettich Drawer Boxes..... 23

Dynapro Drawer Boxes..... 29

True Handleless Range & Appliances ..... 35

Tall and Midi Units ..... 41

Laminate Worktops..... 45

Cutting Laminate Worktops ..... 47

Solid Wood Worktop..... 50

Installation Precautions ..... 51

Fixing..... 51

Jointing Worktops..... 52

Solid Worktop Aftercare Instructions ..... 53

Minerva and Metris Worktop Installation..... 55





## Part One: Working with The Kitchen Depot

- Our Code of Practice
- Our Supply Only Service Agreement
- Reading a Kitchen Depot Plan

# Our Code Of Practice

## Before Installation

All agreed additional building, electrical, plumbing and plastering work must be completed prior to installation of the kitchen. Please provide contact details of every sub-contracted trades person involved in the planned installation to the customer. If it is a rail system kitchen, please check the undercounter appliances are appropriate for the height of worktop you are planning to set - (see appliance section for more detail).

It is imperative that you always respect the customer's home. Courtesy, consideration, and thoughtfulness are to be expressed when you are working in a customer's house. You are expected to include a vacuum cleaner as part of your kit and to use it frequently to keep work area clean and tidy.

- Please use dust sheets whenever and wherever possible.
- Never leave tools on top of worktops.
- Never smoke in a customer's home or within their domestic environment such as gardens or public passageways. Always dispose of your cigarette ends responsibly and tidily.

## Customer Installation Responsibility Agreement

When a customer is using their own fitting team to install their new kitchen, they must sign an agreement confirming that their fitting team has verified the final plan fits before ordering.

Your fitting team must confirm the final plan fits your kitchen space before you order. The Kitchen Depot is not responsible for the final plan's fit or regulatory compliance. We are not liable for poor workmanship, poor installer experience and knowledge, or non-compliance by your fitting team.

By proceeding to order the kitchen, the customer acknowledges and accepts these terms. Ensure your fitting team checks all aspects for a successful installation.

## During Installation

- Always follow the final plan as agreed by The Kitchen Depot and the customer.
- Before the worktops are cut and installed, please ask the customer to confirm that the correct worktop has been delivered. All worktops are to be inspected for damage or manufacturing flaws before they are cut as the tops cannot be replaced once cut.
- Any amendments to the final plan that are proposed on-site must be reported immediately to The Kitchen Depot's Administration Department for approval before the amendments are implemented.
- Before installing each appliance, note and record the respective serial number for the customer's future reference (Serial numbers can be difficult or impossible to locate once the appliance is fitted).
- All worktop joints and cut outs are to be sealed with the correct sealant.
- Laminate splash backs and upstands MUST NOT be fitted behind a heat producing hob
- Always consult with the customer on-site as to the preferred final position of all hardware and handles before holes are drilled.
- All taps to be installed with an isolation valve.



# The Kitchen Depot's Supply Only Service Agreement

Our kitchens are designed to be installed by kitchen fitting professionals and come delivered with an expectation that your installation team have a good knowledge of fitting quality kitchens. We are happy to support and advise your fitter on any issues they may have but ask that they consult the 'Supply Only' guide provided beforehand as it is likely to answer their query.

Where you have elected to appoint your own fitting team to install your new kitchen supplied by The Kitchen Depot, you must be satisfied that the installer accepts full responsibility for ensuring that the final plan designed by The Kitchen Depot will fit your kitchen and complies with all regulations. The Kitchen Depot cannot be held responsible for bad workmanship, failure of fitters to comply with all required regulations or any poor installation practices.

As fitters have their own preferences about the brands they use, kitchen hardware fittings such as worktop bolts, screws, 'L' brackets, etc. are not supplied by The Kitchen Depot. When we supply and fit a kitchen, these are supplied by our own fitters and quoted in our fitting service costs.

Although every effort is made to ensure otherwise, occasionally damages do occur from transit. Upon delivery of the products, you will need to have inspected the products within 48 hours and reported any alleged defect, fault or error before the products are used or fitted. We shall have no liability for any claim in respect of an alleged defect, fault or error which would be apparent on inspection before use or fitting.

There are many elements and components that make up a fitted kitchen; very occasionally there will be elements that are not available, arrive damaged etc. that may cause some delays. The Kitchen Depot accepts no liability for any delays caused by unforeseen circumstances and strongly advise you not to pay a day rate for any kitchen installation to avoid you paying more for your fit than you expected. The Kitchen Depot will not compensate for any delay in your installation.

You may find that you have been delivered a small number of excess panels, plinth, door fronts etc. This is to ensure that your installation goes as smoothly as possible. You will not have been charged for this additional material in your quote. Please be aware that due to the standard lengths of some components there could be a large amount of off-cut material. This is not refundable and is an unavoidable part of the installation process.

## Reading a Kitchen Depot Plan

We use the latest CAD software from Articaad to produce our plans. Alongside these plans we will often provide elevations and pictures to aid you in visualising the final design. These are a guide and although every effort is made to get the visuals to look like the finished kitchen the software does have limitations. For this reason, you must always refer to the plan over any visuals. If in doubt, please speak to one of our designers.

Our kitchen plans are designed to try and be as helpful as we can make them. Our designers make every effort to cover everything that we can in the plan to help you with a smooth installation of the kitchen. This is to help match the customer's desires and expectations and the designer's intention of how it should work and look.

We appreciate that for various reasons there may be cause to adjust the final plan on site:

- Increasing/decreasing corner posts or fillers
- Boxing in material
- Changes due to unforeseen challenges after removal of the old kitchen.

Major changes need to be identified early and discussed with your customer. Our showrooms will be on hand to help and assist, however be aware that any changes requiring extra product will be chargeable to the customer in most circumstances.

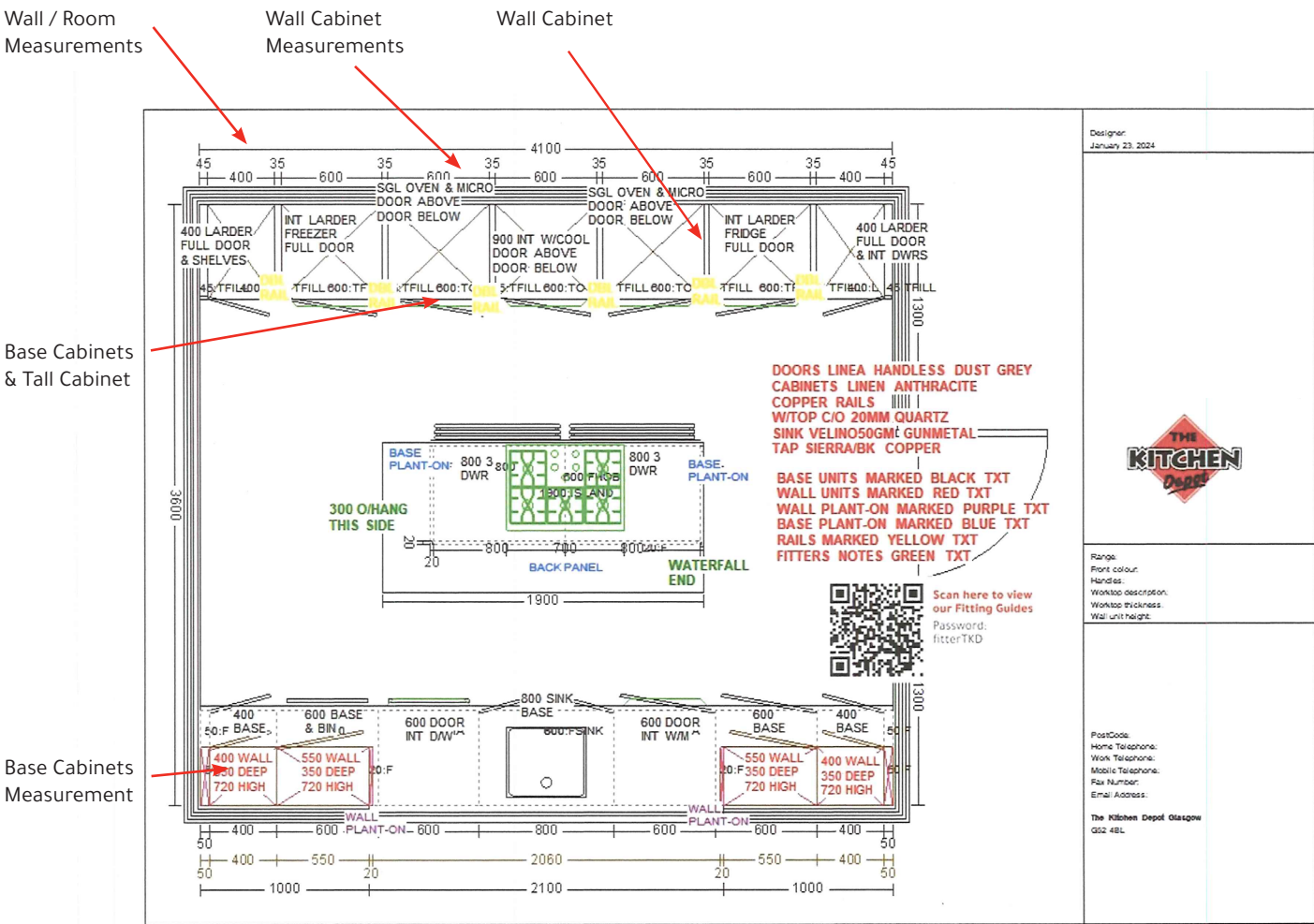

### Plan Abbreviations:

- BEP** Base End Panel - 900 x 650 x 18mm
- WEP** Wall End Panel - 350mm x 960mm x 18mm
- TEP** Tall End Panel - 2400mm x 650mm x 18mm
- FWBP** Full Width Back Panel 2400mm x 900mm x 18mm
- HWBP** Tall End Panel - 650mm x 960mm x 18mm
- SCP** Panel will be made to size (limited finishes available)
- CP** Corner post
- PFILL** This is a filler that is to be cut to size and made from a piece of plinth
- FILLER** This is a filler piece to be cut from door or panel material offcuts or extra material supplied
- SVR** True Handless Vertical Rail Single
- DVR** True Handless Vertical Rail Double
- NB** Panel Material may also have additional description to help you understand which material/finish of the panel. These are either Tongue & Groove, Painted, High Gloss, Cracked, Grained, Semi-Gloss or TKD Matte

### Kitchen Plan Colour Code Prefix

- Base & Larder Units, Base Panels and Fillers will always be in shown as black edged box on the plan with a Black Text Description
- Wall Units, Wall Panels & Fillers will always be in a red edged box with a Red Text Description
- Green Text is an additional note to the fitter or general notes - these are there for a reason so please read them



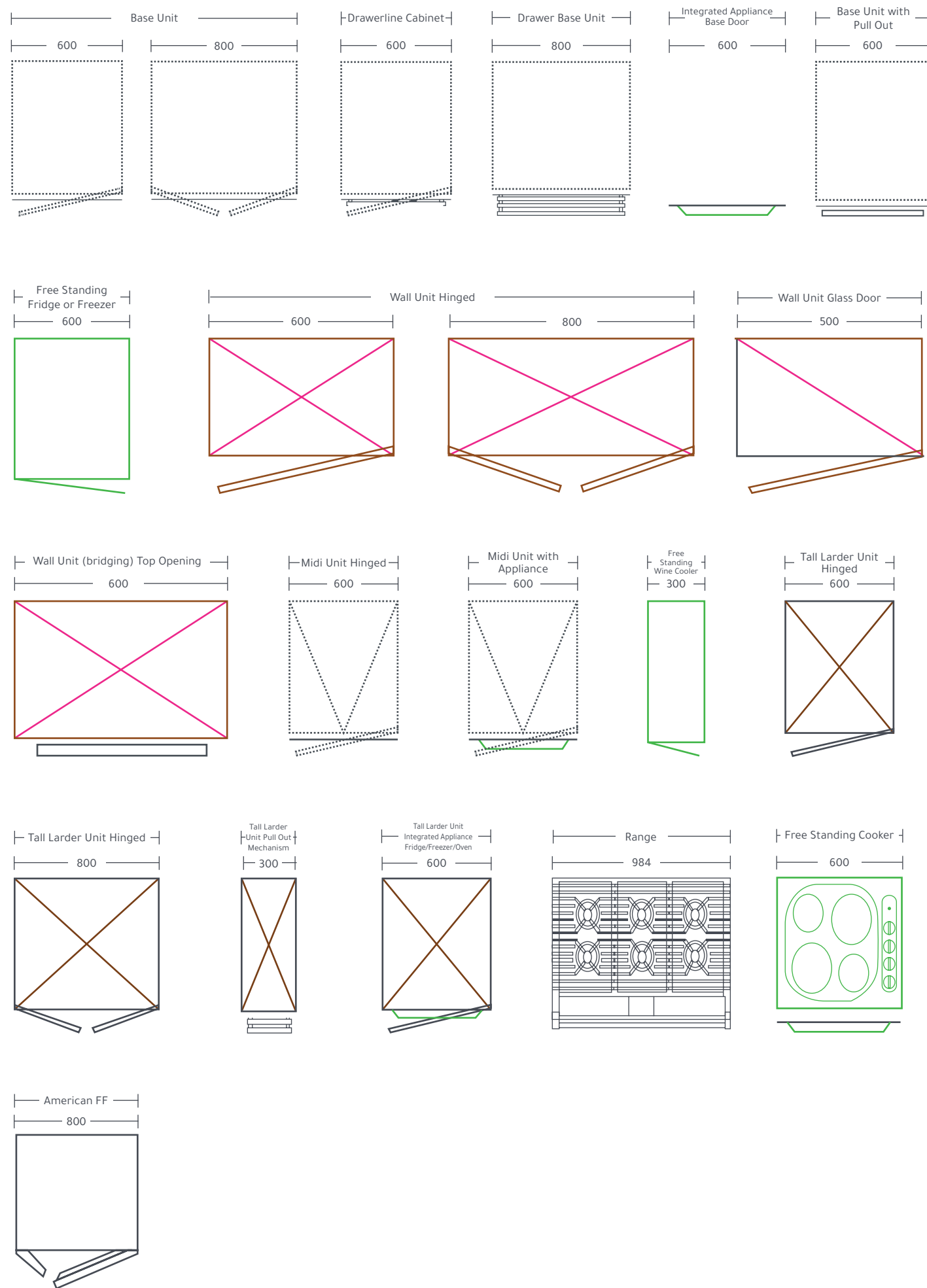

## Part Two: Our Product

- Cabinets
- Construction and benefits - Base and Wall
- Corner Units - L Corner Base and Inline Corner
- Cabinet Features, AFF Setup and Open units
- Hinges - VIDEO
- Drawer units - VIDEO
- Doors and Panels
- Pull outs and Internal Storage
- Appliance Housings
- True Handleless
- Accessories - Worktop - See Linked Videos, Mistral, Solid Wood, Sil granit tap hole



# Construction & Benefits: Base & Wall Units

## Base Units

Our ability to manufacture our own bespoke kitchens is a competitive advantage which allows us to offer a higher specification of materials as standard.

Using the latest technologies, our team of highly skilled machinists ensure our own high standards of quality assurance are upheld. As well as our manufacturing expertise, we have also formed exclusive relationships with carefully selected local suppliers to bring our customers even more stunning style options without compromising on quality

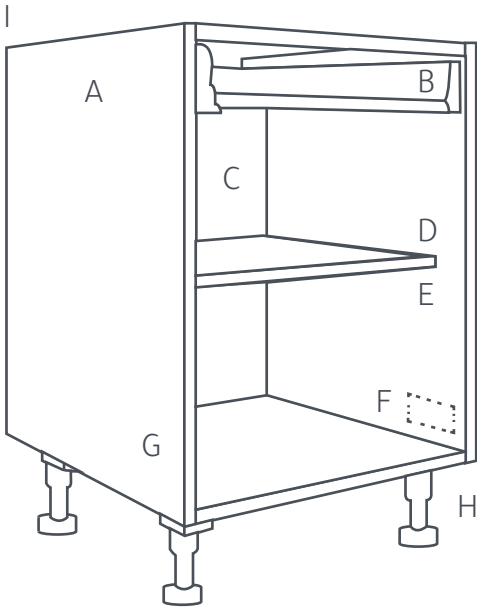

## Features

**A** 18mm premium grade board ensures an industry leading cabinet in both strength and stability

**B** Superior metal drawer boxes with soft close system

**C** Unique 18mm solid back panel ensures rigid cabinet structure

**D** Variable shelves that allow the maximum in storage flexibility

**E** 20 colour matched cabinet options

**F** 3 way, fully adjustable metal soft close door hinge system

**G** Superior 1mm all round ABS edging which prevents water ingress. All edging is colour co-ordinated

**H** Fully adjustable legs

**I** 50mm service void + 40mm voids pull-out cabinets

Drawer box colour co-ordinated

## Wall Units

### Heights Available

**570mm** 1 shelf

**720mm** 2 shelves

**900mm** 3 shelves

### Wall Unit Depths

**300mm**

**350mm**

**Please Note:** 350mm wall depth not available in corner wall units (can be processed as special order).

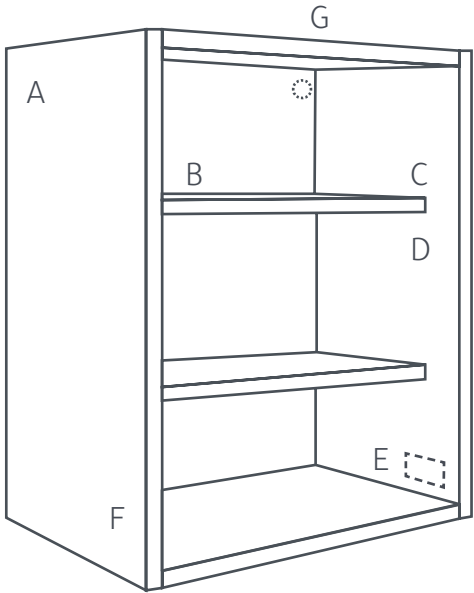

## Features

**A** 18mm premium grade board ensures an industry leading cabinet in both strength and stability

**B** Unique 18mm solid back panel ensures rigid cabinet structure

**C** Two variable shelves that allow the maximum in storage flexibility

**D** 20 colour matched cabinet options

**E** 3 way, fully adjustable metal soft close door hinge system

**F** Superior 1mm all round ABS edging which prevents water ingress. All edging is colour co-ordinated

**G** Concealed wall hanging bracket



**Doors, Panels & Integrated Appliance Housings**

- On our Sienna range, the doors will come drilled on both sides and cover caps will be supplied. We recommend using 16mm screws for attaching the doors. Screws should be hand tightened to avoid over tightening and causing bulging the other side.
- All finished gable ends are 50mm deeper to allow for any scribing that maybe required. Always reduce the finished gable-end to a normal depth of approximately 590mm if they are not required. When an area is highlighted on the plan as FILLER this is to give you flexibility over the final distance. The units need to be spaced away from the wall then you use plinth to cut down to the correct size and insert the filler.

**Base Integrated appliances**

- A cabinet is not required for integrated washing machines, dishwashers, tumble dryers, double ovens or under counter fridges and freezers. All that is required is a undrilled 600mm door fascia. The fixings for the door come with the appliance and are not supplied by The Kitchen Depot. These are very likely not to be soft close.
- All integrated washing machines require a solid base for installation. We recommend that you use a worktop off cut if possible.

**Fridge Freezer Housing**

- The housing for a fridge with a fridge freezer with a 50/50 door combination needs a fixed shelf fitted approximately 120mm from the bottom of the cabinet for the doors to align with the fridge/freezer.

**Oven Housings**

The number of combinations available for appliances in oven housings has dramatically increased with a limited number of door sizes available. Therefore, depending on the combination of appliances the customer has selected it is likely the customer requires a filler panel to make sure there are no unsightly gaps. We will provide a 140mm drawer front which will need to be cut to size on site. Edging tape and touch up paint is available if required, but on our installations, we cut as close to the oven as possible and will leave the unfinished end facing the oven.



# Corner Units: L Corner Base & Inline Corner

**L Corner Base**

- L Corner Base units are supplied Flat pack. Please read the instruction provided.
- The corner post for the L-corner unit is attached to the door.
  - Only one handle is needed on the door without the corner post.
  - Bridging plates should be used to attach the corner post to the door.
  - Not all ranges have pre-assembled corner posts available. Therefore, you will receive one 715 x 147 doors for you to measure and construct a corner post that would need to be either screwed together or, our preferred option, mitred and glued together with wood adhesive and clamped overnight. Any excess glue can then be removed easily once set and gives a cleaner finish.
  - When installing laminate worktops, please be aware that a section of the top of any L corner base unit will have to be cut to allow any worktops joints to fit.

**L-SHAPE**

A rigid building block available in three ergonomically set sizes.

+ All units 570mm

**UNITS AVAILABLE:**

892 x 892
932 x 932
1032 x 1032





### Base Inline Corner

#### Purpose of a Corner Post?

A corner post is required for EVERY Corner Inline Corner Solution.  
The consequence of not installing a corner post could be as follows:

- Binding Doors
- Handle damage to doors when opening.
- Drawer unit obstruction due to handle placement
- Dishwasher obstruction
- Symmetry lost with wall units

The size of your corner post will be highlighted on your kitchen plan. The standard size being 30mm x 30mm although this can increase or decrease depending on the design.

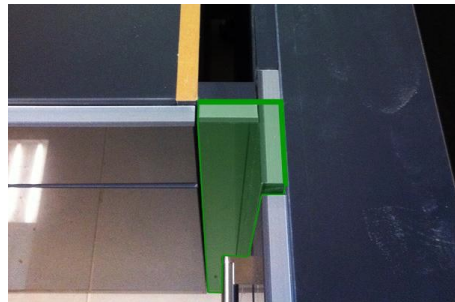
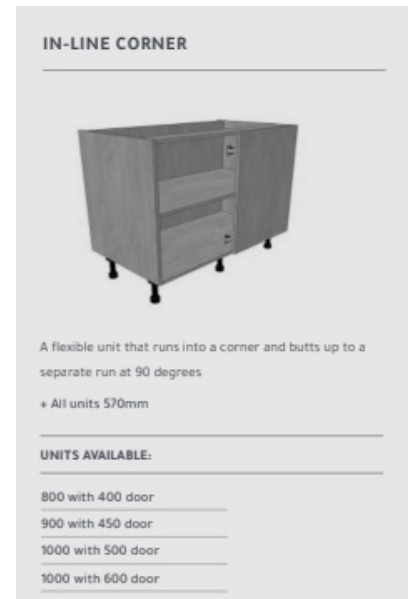

#### Points to Note:

- Corner posts are supplied as 150 doors. These are to be reduced and constructed into the required size indicated on your kitchen plan.
- We do not supply fixed sized corner posts; this is because fixed corner posts give you less flexibility on site.

### Correct Door Configuration - VOID

Your plan provided by The Kitchen Depot will show you the appropriate service void. Please see the diagram attached for guidance and clarification



## Cabinet Features, AFF Setup & Open Units



### Quad Ends

- The quad end is made up of two pieces. The quad end is put into place then the tall end panel is battened away from the cabinet to fit flush with the quad end, which completes the look.

### Wireworks, Bin and Internal Accessories

- All wireworks, pull outs, storage mechanisms and bins have templates and fitting instructions within the packaging.

### AFF Larder Setup

- Check the height and width measurement of your AFF. This can be different depending on manufacturer.
- Depth of the AFF will always be deeper than the cabinet. The AFF is to be positioned proud of the units to ensure the opening of the doors.
- 18mm Panels are to be fitted either side of the bridging unit to accommodate the width of the AFF.

We do not supply scribing panels for the internal show ends.



A plinth return will be required to finish the plinth.

### Open Units

- Unless specified open wall units are supplied as the same material as the kitchen cabinet.
- Unless specified a floating shelf is supplied with the unit giving you the flexibility of the shelf placement.
- We recommend installing the open units flush with the door rather than the cabinet giving you a clean finish.



Scan/click here to view the all the Fitting Guides.

Password: **fitterTKD**



Hinges

Our Standard Hinges

- Hettich Sensys 90 Degree Soft Close
- Used on all standard base and wall cabinets.
- Hettich Sensys 165 Degree Soft Close
- Used on all L Corner Cabinets and units with internal drawers.
- Hettich 90 Sensys 90 Degree Standard Hinge - non soft close
- To be used with integrated Fridge Freezers



Scan/Click for the  
Attachment, Removal  
and Adjustment Tutorial

Bridging Hinge - Hafele

- Extremely adjustable: Four standard colours and a product series for handle-free applications
- Fitting for screw fixing with pre-mounted Euro screw, front panel without tools, for sliding onto pre-mounted fixing screws.



Scan/Click for the  
video tutorial



Scan/Click for the  
PDF Instructions



Hinges

All Hettich hinges come with easy adjusters to give you more flexibility when fitting. These can be adjusted up and down, left and right, and forward and back, helping you achieve perfect levels between all the doors. Hinges can also be easily removed from the plates with a small clip at the back of the hinge.

Most of our cabinets come delivered with the hinge plates attached.

**PLEASE DO NOT REMOVE THE HINGE PLATES.** Doing so can mean the pre-drilled hole can become threaded if you remove and reattach the plates. This will result in the plate starting to come away from the cabinet and the hinge to fail or come away completely. If you wish to brace cabinets together, this can be on show, if done neatly. Alternatively, if you wish the bracing to be hidden, attach through the hinge plate, at the point highlighted by the arrow to the left, using a screw with a head size of 3.



## Hinges

### Fast assembly concealed hinge

- ▶ Intermat
- ▶ Installation notes

#### Installation

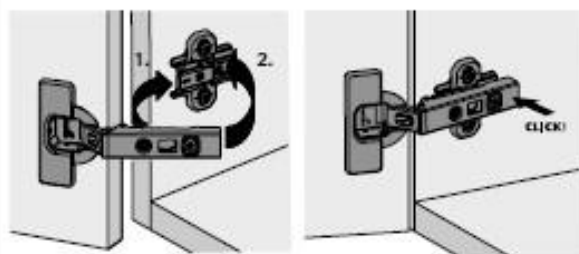

#### Removal

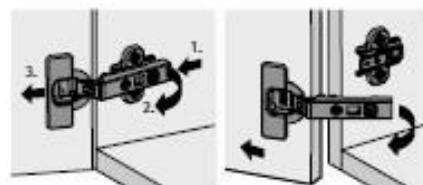

#### Overlay adjustment

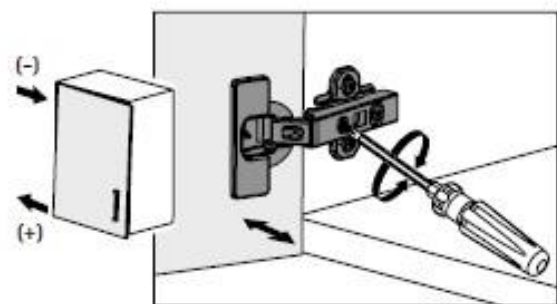

#### Depth adjustment

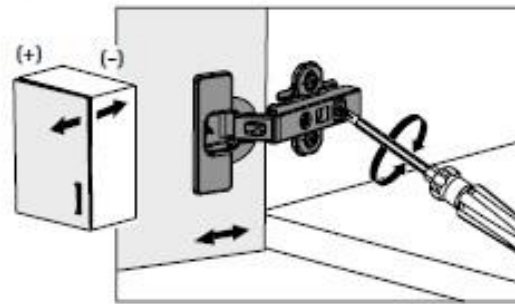

#### Oblong hole height adjustment

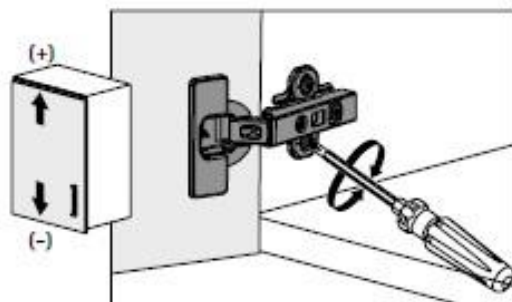

#### Eccentric cam height adjustment

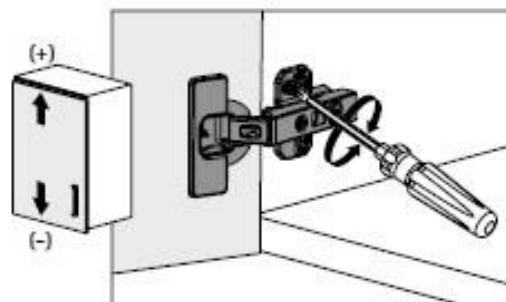

#### Cup assembly for screwing on

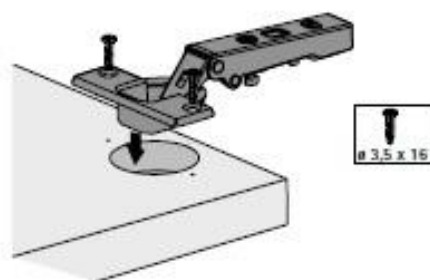

#### Cup assembly for pressing in

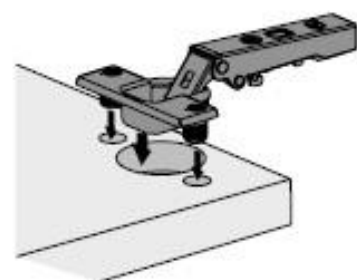

Drawers





# HAFELE DRAWER POSITIONS



Drawer Height 140 (3 pan)

	Height From Bottom	Centre Point to Outer Edge
A	60mm	30mm
B	92mm	30mm

Middle Pan Drawer 283 (3 pan)

	Height From Bottom	Centre Point to Outer Edge
A	60mm	30mm
B	92mm	30mm

Top Pan Drawer 355 (2 pan)

	Height From Bottom	Centre Point to Outer Edge
A	60mm	30mm
B	92mm	30mm

Bottom Pan Drawer 283 & 355 (2 & 3 pan)

	Height From Bottom	Centre Point to Outer Edge
A	73mm	30mm
B	105mm	30mm

# HAFELE DRAWER POSITIONS

## 2 DRAWER - TRUE HANDLELESS



Top 355 drawer

	HEIGHT FROM BOTTOM	CENTRE POINT TO OUTER EDGE
A	90MM	29MM
B	120MM	29MM

Bottom 355 pan drawer

	HEIGHT FROM BOTTOM	CENTRE POINT TO OUTER EDGE
A	75MM	29MM
B	105MM	29MM

**PLEASE NOTE:**  
We suggest using 20mm screws for True Handleless as 16mm screws may not be deep enough.

# HAFELE DRAWER POSITIONS

## 3 DRAWER - TRUE HANDLELESS



### Top 160 drawer

	HEIGHT FROM BOTTOM	CENTRE POINT TO OUTER EDGE
A	60MM	29MM
B	90MM	29MM

### Middle 160 pan drawer

	HEIGHT FROM BOTTOM	CENTRE POINT TO OUTER EDGE
A	90MM	29MM
B	120MM	29MM

### Bottom 325 pan drawer

	HEIGHT FROM BOTTOM	CENTRE POINT TO OUTER EDGE
A	75MM	29MM
B	105MM	29MM

**PLEASE NOTE:**

We suggest using 20mm screws for True Handleless as 16mm screws may not be deep enough.



## HETTICH DRAWER POSITIONS

## Doors

Doors will come pre-drilled/bored for your convenience. On our Sienna range, the doors will come drilled on both sides and cover caps will be supplied. All doors can be adjusted easily using the Hettich hinges. We recommend using 20mm screws for attaching the doors. Screws should be hand tightened to avoid over tightening and causing bulging the other side.

## Pan drawer fronts

These measurements are guidelines only. Measurements must be checked on site as conditions and layout of other units can alter placements marginally. Our door ranges come from the top door suppliers in the United Kingdom and can be used on a number of different types of drawer solutions. Therefore, it is not possible to have the pan drawers pre marked. However, with Hettich, our premium components supplier of drawers and hinges you can make height adjustments using the scroll wheels on side of drawer runners meaning you can get a great finish every time.



Pan drawer heights

C	O
B	O
A	O

Drawer heights 140 (3 pan)

	HEIGHT FROM BOTTOM	CENTRE POINT TO OUTER EDGE
A	43MM	37MM
B	75MM	37MM

Middle pan drawer 283 (3 pan)

	HEIGHT FROM BOTTOM	CENTRE POINT TO OUTER EDGE
A	42MM	37MM
B	74MM	37MM
C	170MM	37MM

Middle pan drawer 355 (2 pan)

	HEIGHT FROM BOTTOM	CENTRE POINT TO OUTER EDGE
A	38MM	37MM
B	70MM	37MM
C	190MM	37MM

Bottom pan drawer 283 & 355 (2 & 3 pan)

	HEIGHT FROM BOTTOM	CENTRE POINT TO OUTER EDGE
A	58MM	37MM
B	90MM	37MM
C	190MM	37MM

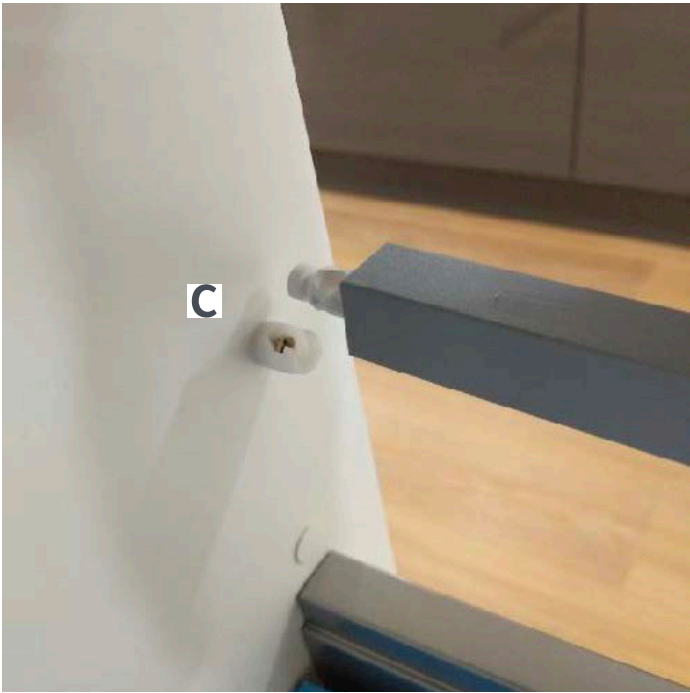
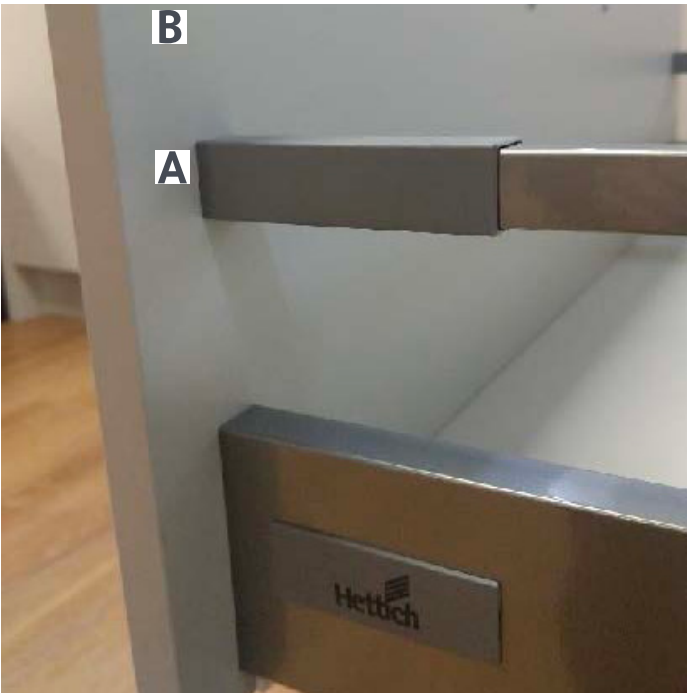

Drawer Adjustments

The drawer panel can be comfortably adjusted in three dimensions.

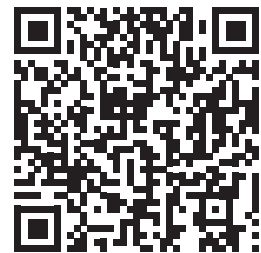
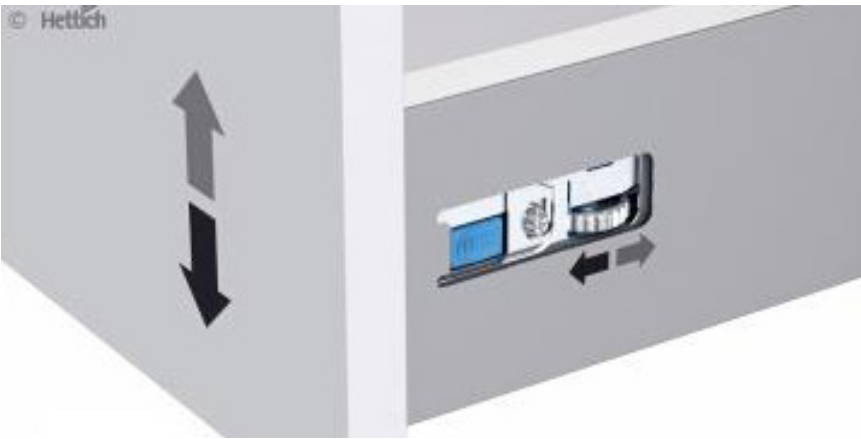
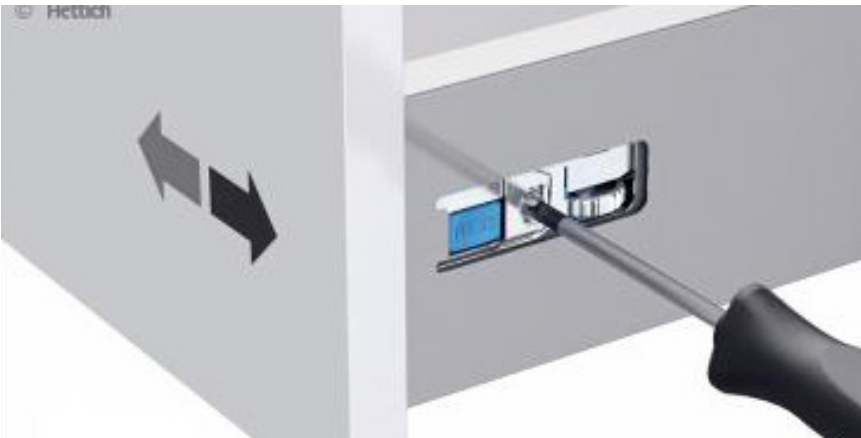

Scan/click here to view the video tutorial

# HETTICH DRAWER POSITIONS

## 2 DRAWER - TRUE HANDLELESS

C	O
B	O
A	O

Drawer heights 355 top

	HEIGHT FROM BOTTOM	CENTRE POINT TO OUTER EDGE
A	50MM	37MM
B	72MM	37MM
C	105MM	37MM

Middle pan drawer 355 bottom

	HEIGHT FROM BOTTOM	CENTRE POINT TO OUTER EDGE
A	40MM	37MM
B	62MM	37MM
C	95MM	37MM

**PLEASE NOTE:**  
We suggest using 20mm screws for True Handleless as 16mm screws may not be deep enough.



# HETTICH DRAWER POSITIONS

## 3 DRAWER - TRUE HANDLELESS

C	O
B	O
A	O

### Drawer heights 160 top

	HEIGHT FROM BOTTOM	CENTRE POINT TO OUTER EDGE
A	25MM	37MM
B	47MM	37MM
C	80MM	37MM

### 160 Middle

	HEIGHT FROM BOTTOM	CENTRE POINT TO OUTER EDGE
A	50MM	37MM
B	72MM	37MM
C	105MM	37MM

### Bottom pan drawer 355 (2 pan)

	HEIGHT FROM BOTTOM	CENTRE POINT TO OUTER EDGE
A	35MM	37MM
B	58MM	37MM
C	90MM	37MM

**PLEASE NOTE:**  
We suggest using 20mm screws for True Handleless as 16mm screws may not be deep enough.



# DYNAPRO 40/80KG

### For use with our wooden drawer boxes

The Dynapro slide allows the use of classic wooden drawers which allow adjustment in all directions. The height, side and depth are conveniently adjusted using the front locking device on the bottom of the drawer. The drawer is tilted using the adjustment adapter on the back of the drawer. The slide system is designed to accommodate a weight of up to 70 kg with a soft-close slide action.



### Component Parts:

/ GRASS DYNAPRO  
RUNNERS



/ GRASS DYNAPRO  
FRONT & REAR  
FIX CLIPPINGS



### Fitting Instructions:



Scan/click here to  
view the instructions  
for installing and  
adjusting the Grass  
drawer box system.



Scan/click here to  
view the supplier  
information.



# DYNAPRO

Planungshinweise/Installation information/Instructions de planification/Istruzioni per la progettazione/  
Indicaciones de planificación/Installations information/Технические данные

113378 - 03/2017



Einbaumaße/Installation dimensions/Cotes de montage/Misure di montaggio/  
Medidas de montaje/Installations mått/Установочные размеры

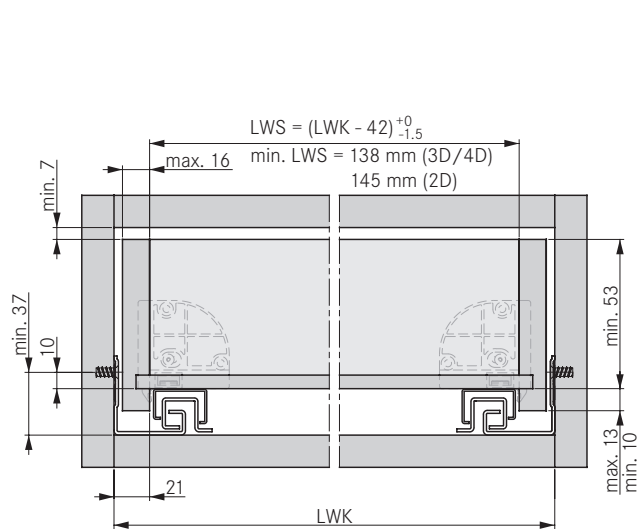

Schubkasten/Drawer/Tiroir/Cassetto/Cajón/Låda/Выдвижной ящик

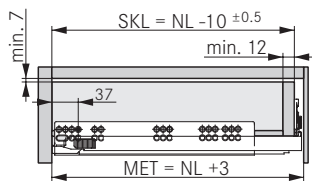

Innenschub/Inset drawer/Tiroir interieur/Cassetto interno/Cajón interior/  
Innerlåda/ Внутренний выдвижной ящик

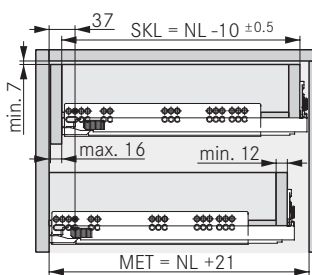

Befestigungspositionen für Vollauszug/Fastening positions for full extension slide/Positions de fixation pour sortie totale/Posizioni di fissaggio per estrazione totale/  
Posiciones de fijación para guía de extracción completa/Infästningspositioner för fullutdragsskena/Позиции для закрепления направляющих полного выдвижения

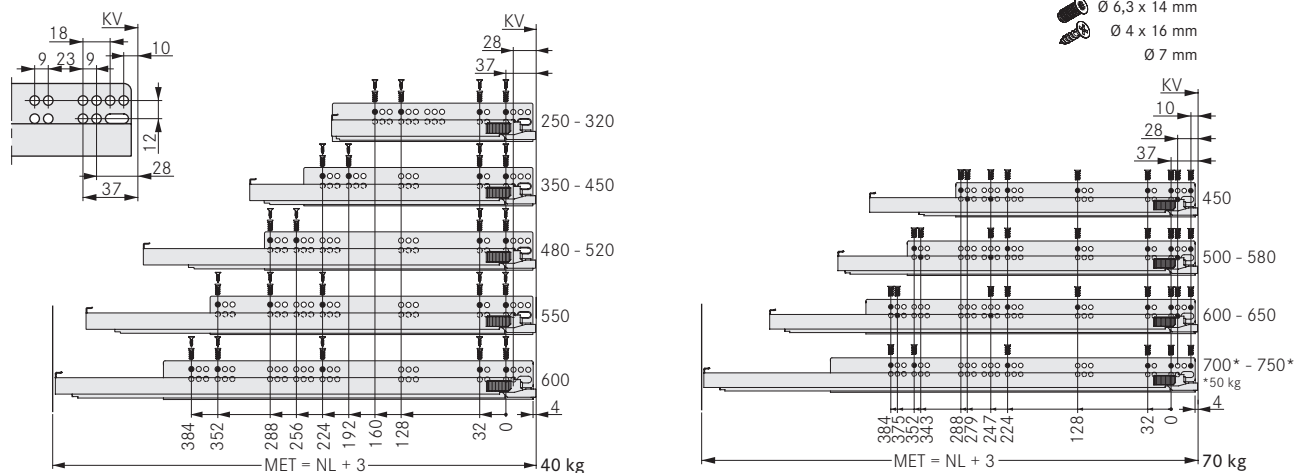

## LEGENDE/LEGEND/LÉGENDE/LEGENDA/LEYENDA/FÖRKORTNINGAR/УСЛОВНЫЕ ОБОЗНАЧЕНИЯ

**KV** Korpurvorderkante/Front edge of cabinet/Chant avant caisson/Fondo anteriore del mobile/Canto frontal del módulo/Framkant skåp/Передняя кромка корпуса

**LWK** Lichte Weite Korpus/Inside cabinet width/Largeur intérieure caisson/Luce libera mobile/Ancho interior del módulo/Innermått skåp/Внутренняя ширина корпуса

**LWS** Lichte Weite Schubkasten/Internal drawer width/Largeur intérieure tiroir/Luce libera cassetto/Ancho interior del cajón/Innermått låda/Внутр. ширина выдвижного ящика

**MET** Mindesteinbautiefe/Minimum installation depth/Profondeur minimum de montage/Profondità minima d'incasso/Profundidad de montaje mínima/Minsta inbyggnadsdjup/Миним. установочная глубина

**NL** Nennlänge/Nominal length/Longueur nominale/Lunghezza nominale/Longitud nominal/Nominell längd/Номинальная длина

**SKL** Schubkastenlänge/Length of drawer/Longueur du tiroir/Lunghezza del cassetto/Longitud del cajón/Lådlängd/Длина выдвижного ящика

www.grass.eu, info@grass.eu



# DYNAPRO

Wichtige Hinweise/Important information/Informations importantes/Avvertenze importanti/Indicaciones importantes/  
Viktig information/Важные примечания

113378 - 03/2017

Transport/Transport/Transport/Trasporto/ Transporte/Transport/Транспортировка

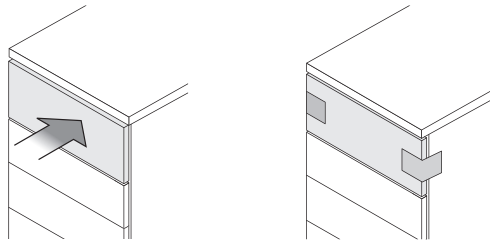

## Montage/Assembly/Montage/Montaggio/Montaje/Monteringsanvisning/Монтаж

1

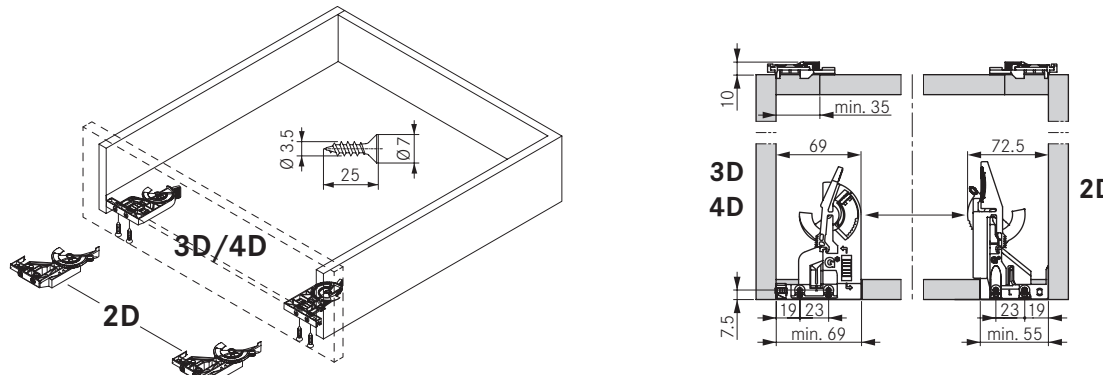

2

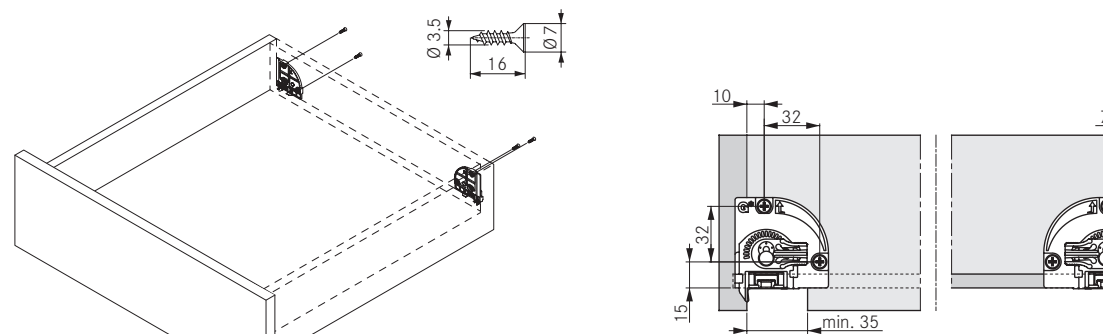

3

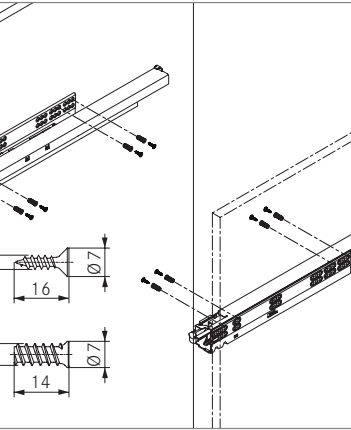

4

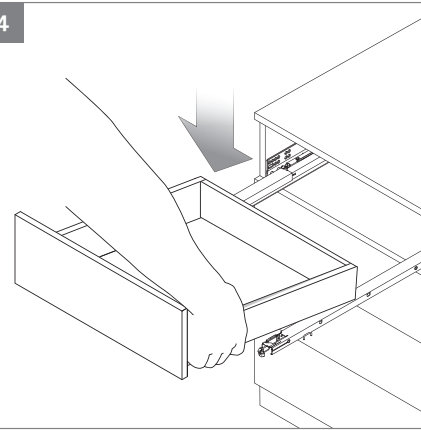

5

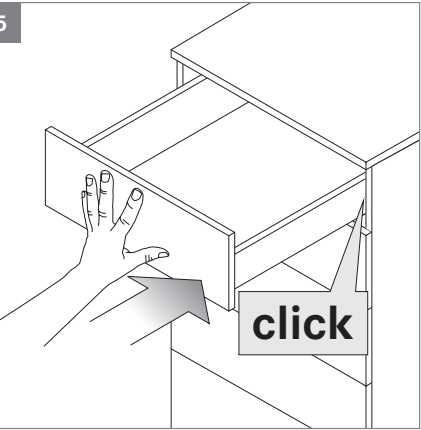

www.grass.eu, info@grass.eu



# DYNAPRO

Verstellungen / Adjustment / Réglages / Regolazioni / Ajustes / Justering / Види регулировки

113378 - 03/2017

	Dynapro 3D/4D	Dynapro 2D
<p>Max. + 3.5 mm</p>		
	Dynapro 2D/3D/4D	
<p>Max. + 4.0 mm</p>		
<p>Max. ± 1.5 mm</p>	<p>1</p>	<p>2</p>
	<p>3</p>	
	4D	
<p>Max. + 3.5 mm</p>		

## Matrix Box S Installation, Adjustment and Removal



Scan/click here to view the video tutorial

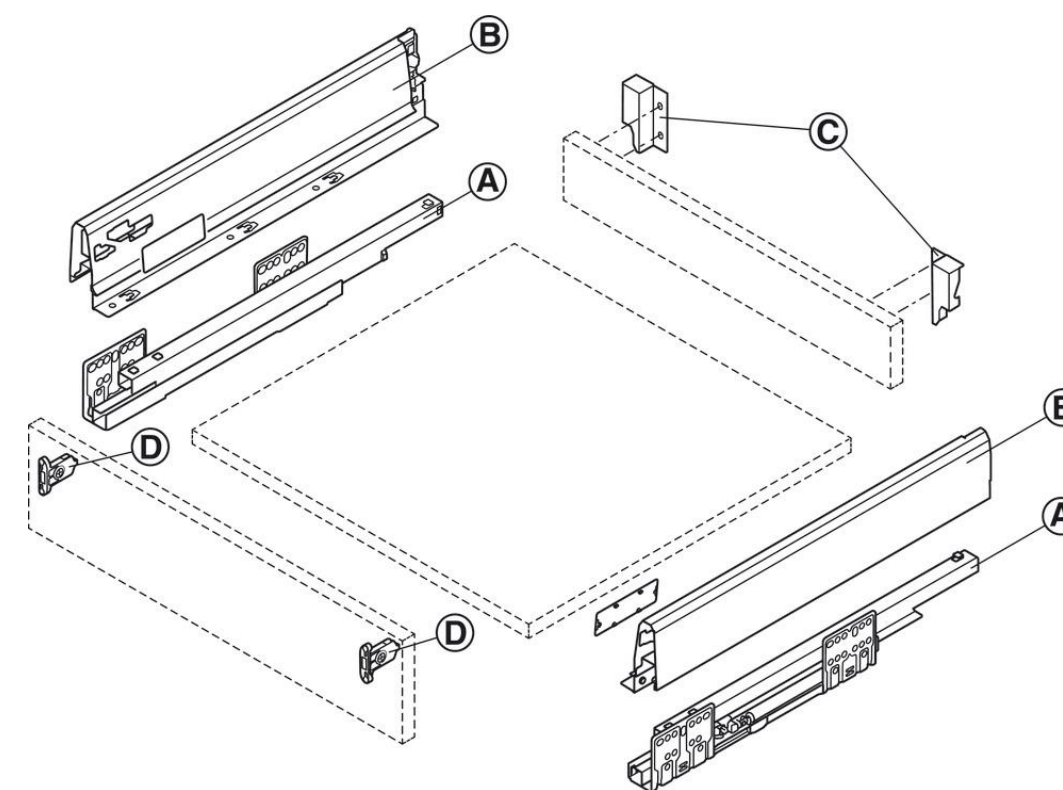
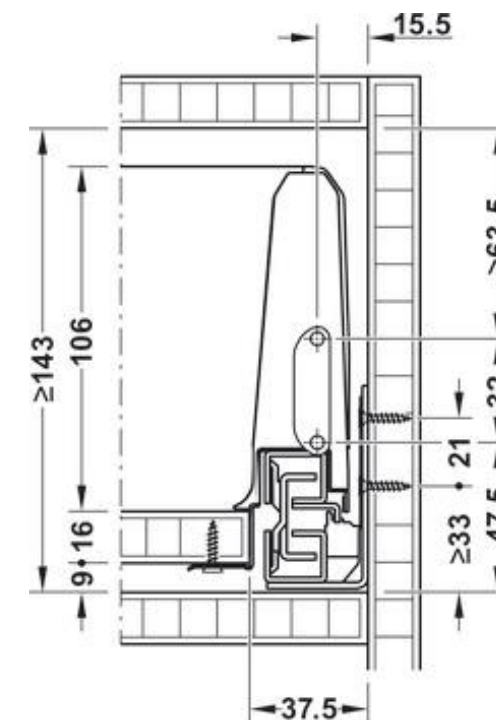





True Handleless

# True-Handleless Range & Appliances

## Undercounter Appliances

The rail system is a relatively new concept and some appliance models require some adjustment to make it work. Dishwashers heights should be no higher than 820mm. Integrated appliances will need to be lowered to their lowest setting, slid into place and then raised up to the rail. Then the door should be attached. **You may find that your appliance will not go low enough. In this instance the only course of action is to RAISE the worktops of the entire kitchen or change the appliance. To save you inconvenience, please check this BEFORE you begin installation.**

Please be aware that templates provided with your appliances for door attachment are unlikely to be suitable for the rail system. Therefore, please do not use these and measure accurately, on site, the required door position before attaching

## Oven fillers

On a rail system kitchen, you will be provided with oven fillers. These are to avoid unsightly gaps between the rail and the oven. On double oven or combination ovens you may need to cut some of these to size.

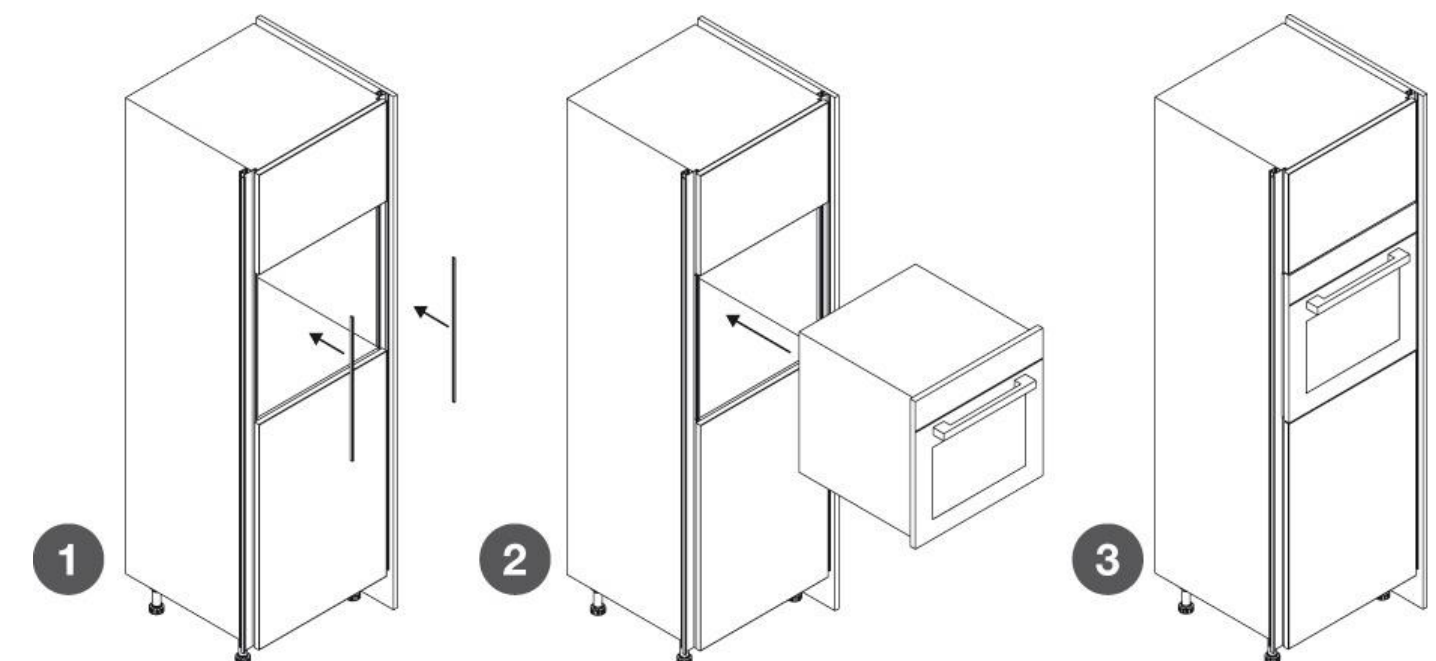



## Base Cabinets First

Many of the greatest innovations are born from the simplicity of idea. The Zara Handleless is one such development. The base cabinet is routed to receive the TOP-RAIL. Our range of doors are reduced to a height of 685mm to allow easy access.

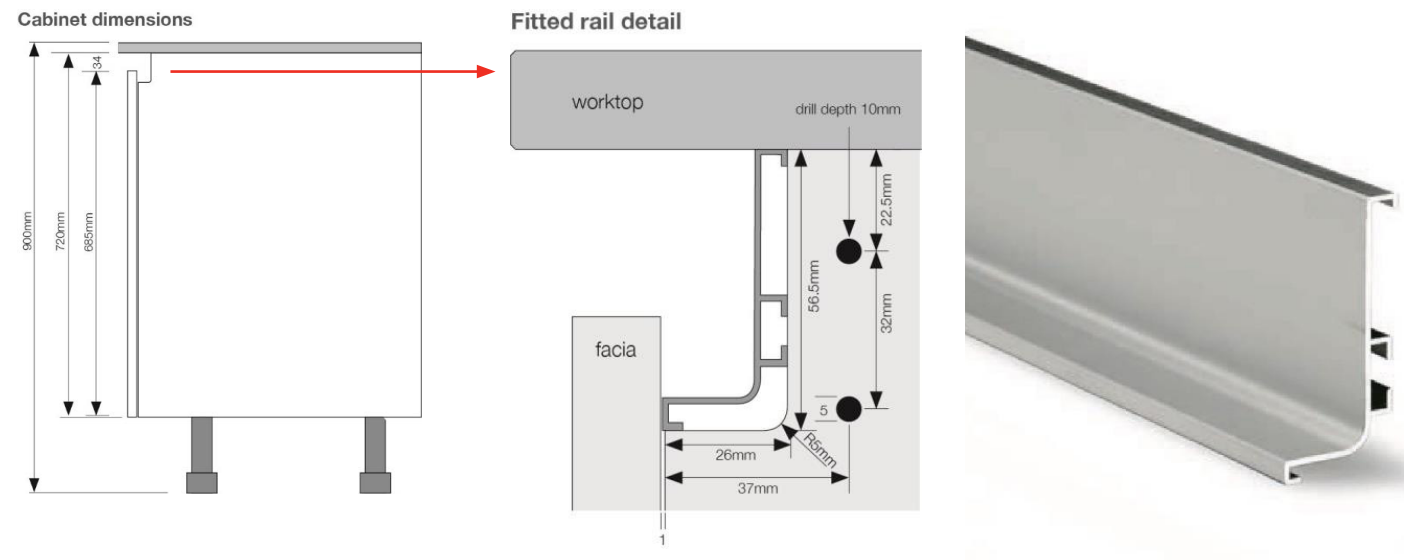

## Top Rail

Kit includes 4100mm of Top Rail and x4 Fixing Clips. You order these as a set and cut to suit on site.

## The Detail

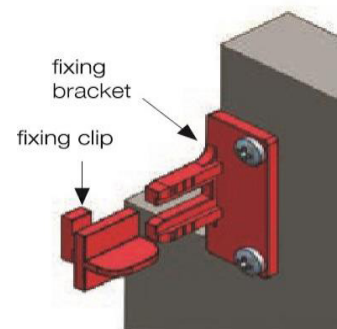

If your run of units exceeds 4100mm then order BASE-TOP EXT KIT.

BASE-TOP EXT KIT includes an additional 4100mm Top Rail and a clever connection bracket,

## Installation

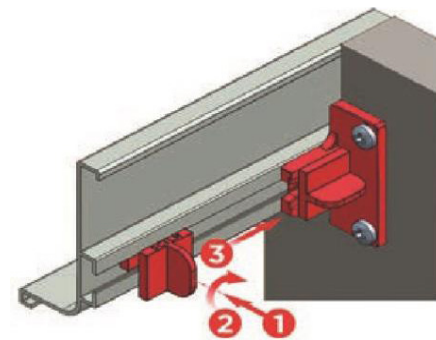

1. Screw fixing bracket into place
2. Add Top Rail profile
3. Slot fixing clip into the rail at rear of the Top Rail, then turn and push into the fixing bracket.

## The Corner Solutions

The corner connectors are required for connecting two rails into a corner. Secure the connector to the rail profiles with screws supplied.

### Internal Top Rail Connector

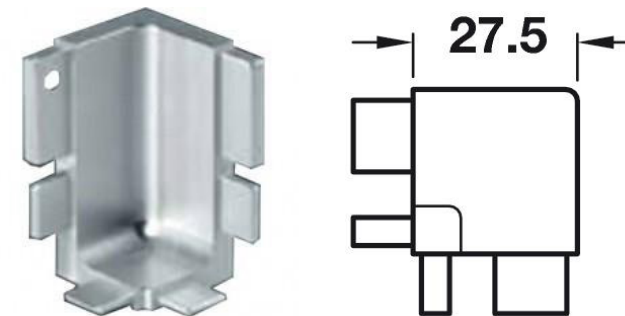

### External Top Rail Connector

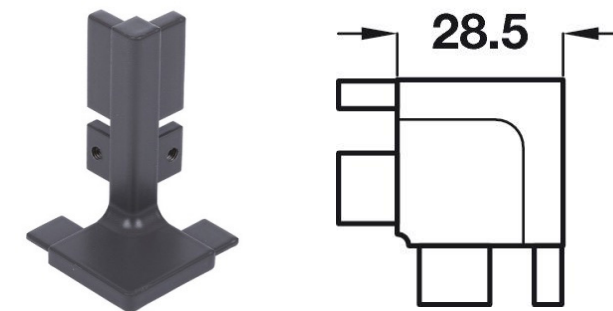

### External Mid Rail Connector

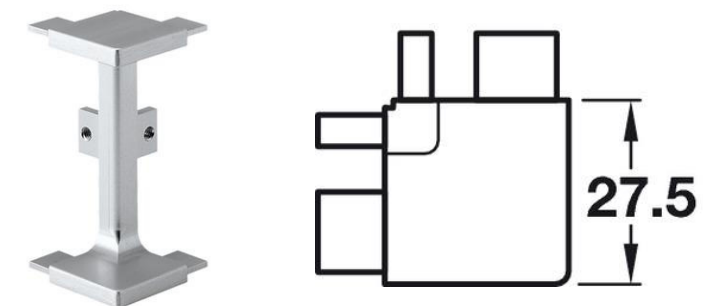

### Internal Mid Rail Connector

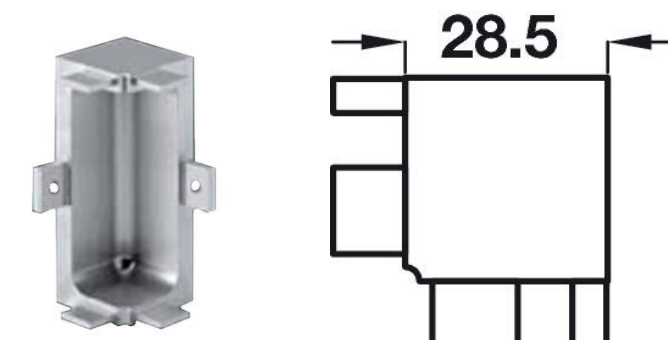



## Breaking The Line

There are occasions when both top and mid rail runs have to be broken, the principal cause being the installation of a built-under oven or a free-standing appliance. These will often be broken naturally with a base end panel or cabinet like the pictures below.



There are occasions when both top and mid rail runs have to be broken, the principal cause being the installation of a built-under oven or a free-standing appliance. These will often be broken naturally with a base end panel or cabinet like the pictures below. Occasionally the above may not be a suitable way to finish an end. In those cases, you will be provided with an end cap to finish the rail off neatly. Made from the same aluminium and finish they match both Top Rail and Mid Rail perfectly. A screw is supplied to attach the end cap firmly to the rail. The clips simply screw into position.

### BASE-TOP END CAP KIT



Kit features a cleverly designed end cap and fixing bracket.

### BASE-MID END CAP KIT



Kit features a cleverly designed end cap and fixing bracket.

## Base Cabinets First

The Zara Handleless series offers an ingenious MID-RAIL system which runs mid-cabinet and allows easy access to all fascias. The base cabinet is routed to receive the MID-RAIL. Our range of drawers and pan drawers are reduced to a height of 160mm and 325mm respectively.

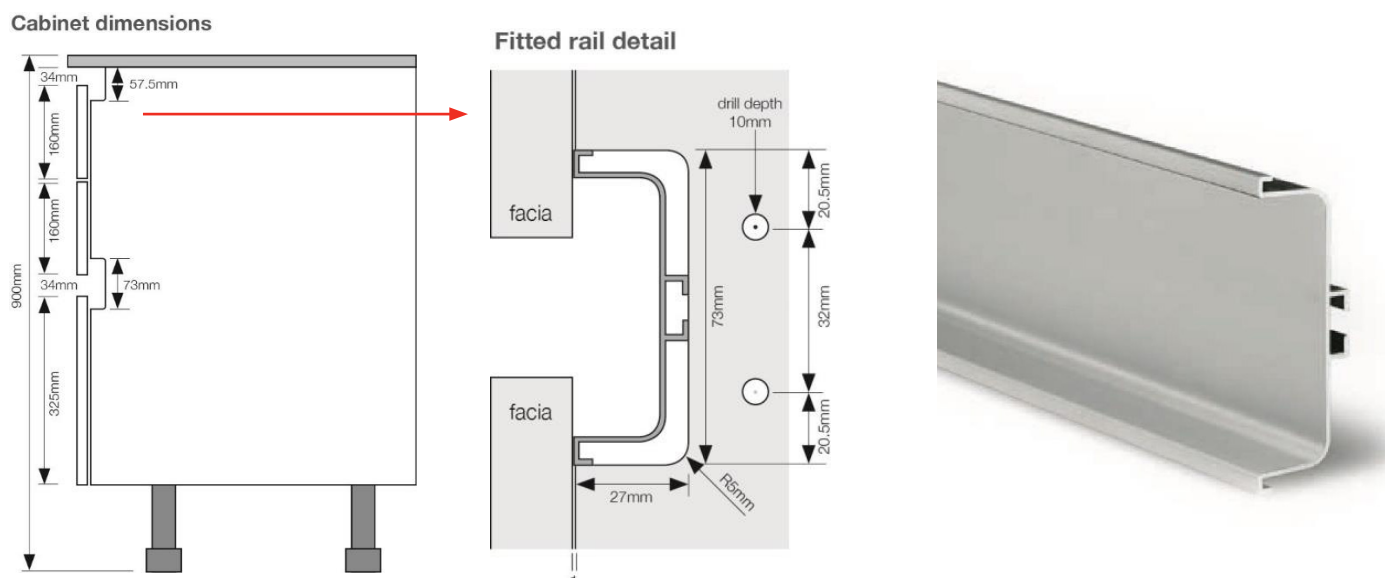

### Mid Rail

BASE-MIDRAILKIT retail £135.00

Kit includes 4100mm of Top Rail and x2 Fixing Clips. You order these as a set and cut to suit on site.

### The Detail

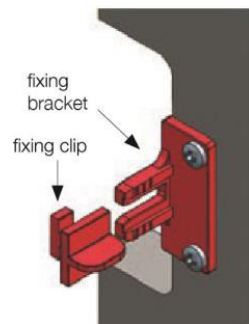

If your run of units exceeds 4100mm then you need a rail connector.

BASE-MID EXT KIT includes an additional 4100mm Mid Rail and a clever connection bracket,

### Installation

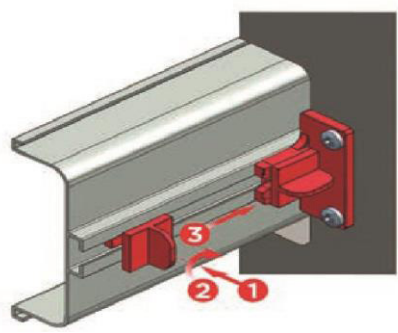

1. Screw fixing bracket into place
2. Add Top Rail profile
3. Slot fixing clip into the rail at rear of the Top Rail, then turn and push into the fixing bracket.

We offer 4 different True Handleless base cabinets:

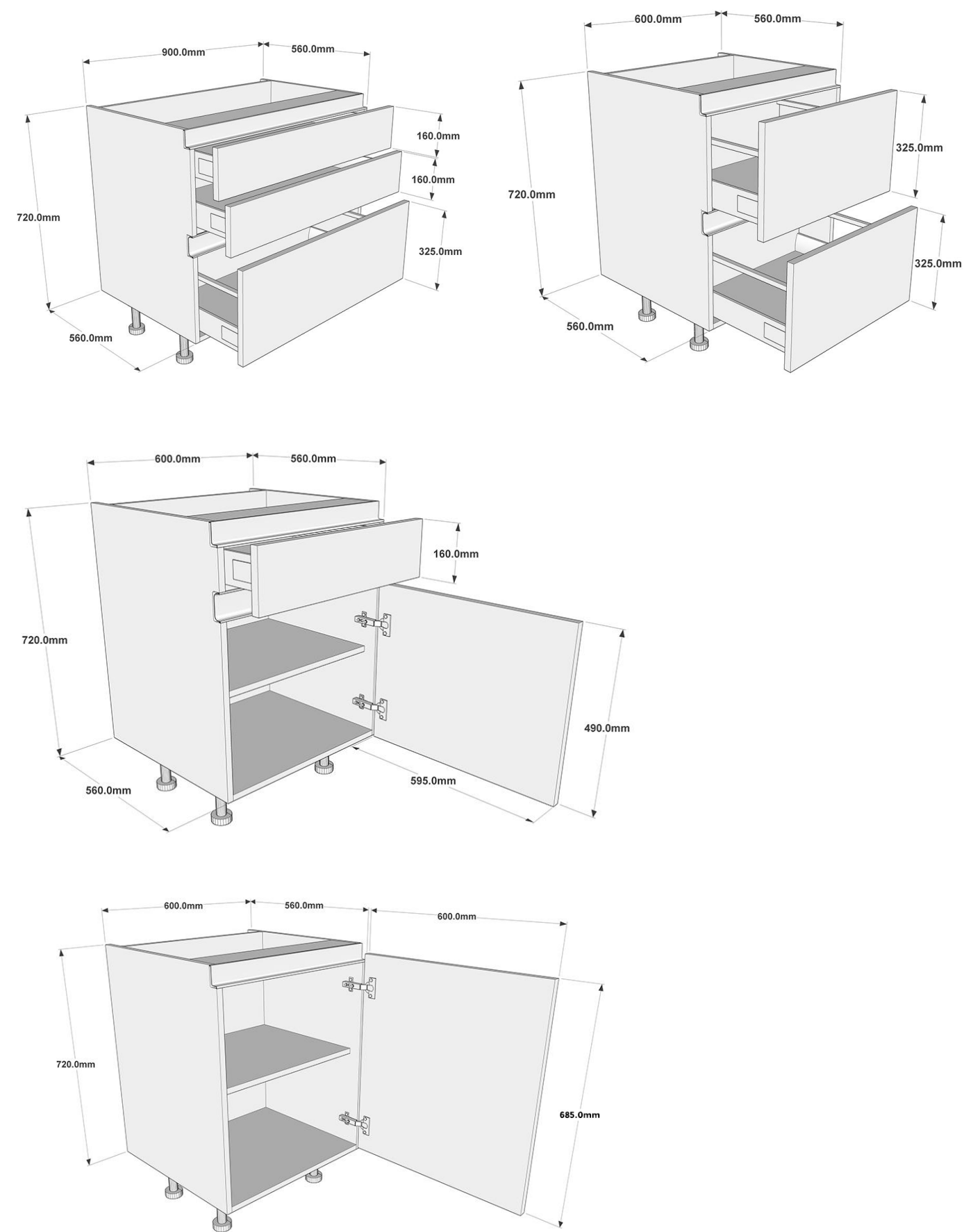

# Tall and Midi Units

Two options are offered:

## Double Vertical Rail

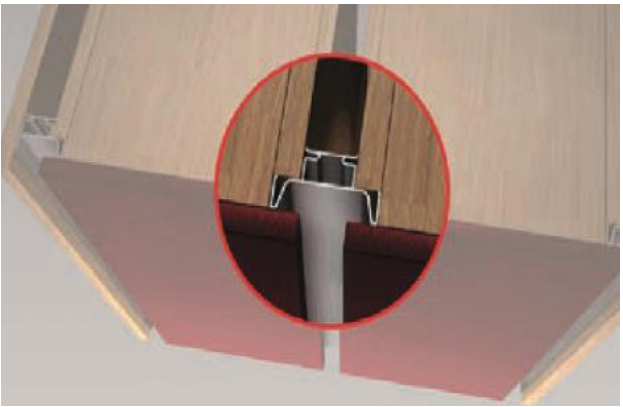

Used in a bank of tall units and sits between two cabinets.

Well-proportioned, it requires a 35mm gap between units. It cleverly allows for easy opening when two opening doors meet.

## Single Vertical Rail

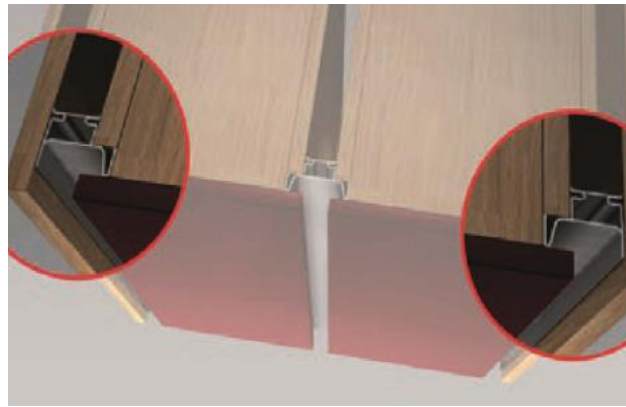

Used when a single unit stands alone, on the end of tall cabinet.

Runs on when you have an opening door to one side and do not require access to a door on the opposite side.

## Spacer detail (back of unit)

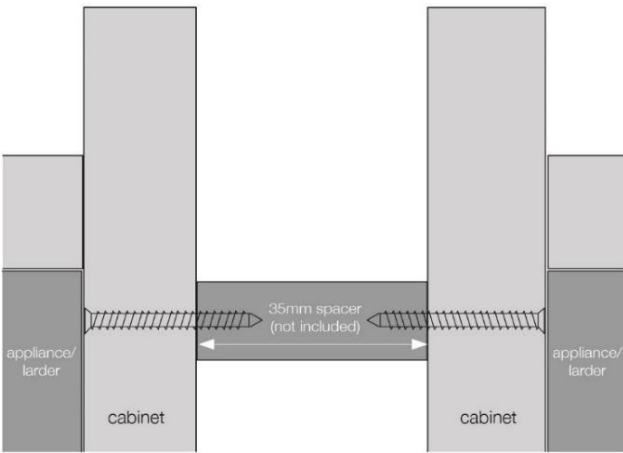

## Spacer detail (back of unit)

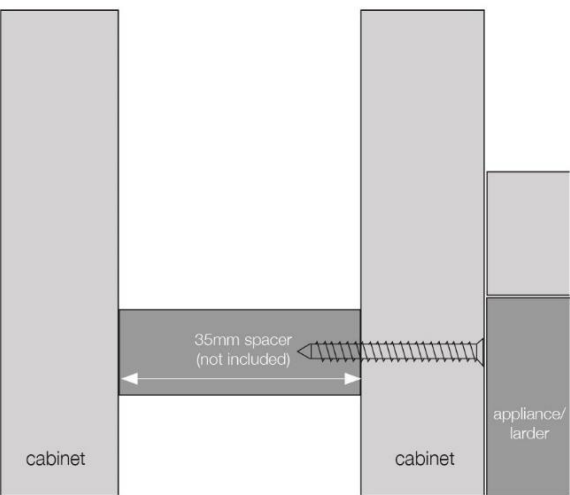



**Double Vertical Rail**

LARDER-DOUBLERAIL is supplied in 4200mm lengths, ready for cutting down on site.

LARDER-DOUBLE RAIL is fixed using 4 x 30mm screws [counter sunk.] It is best practice to position the screw holes in the cabinet so that they are concealed behind hinge plates when the internal components are added.

LARDER DOUBLE RAIL requires a 35mm spacer between the two cabinets.

LARDER DOUBLE RAIL requires the cabinet gable.



Spacer detail (back of unit)

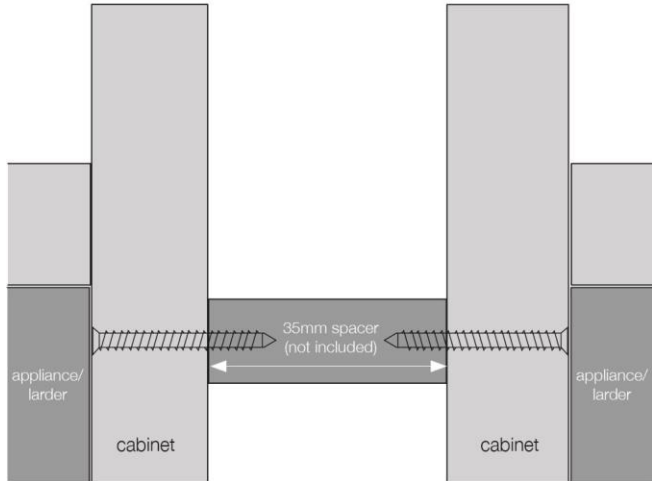

Rail profile

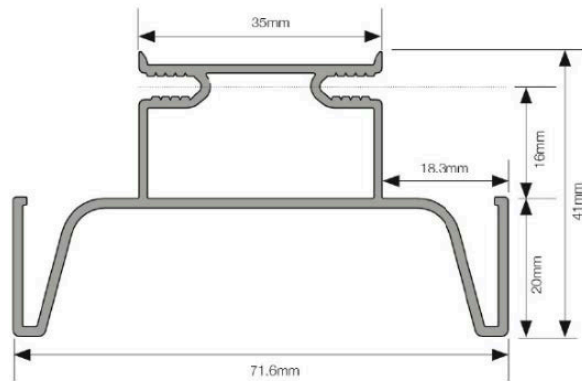

Fitted rail detail (front of unit)

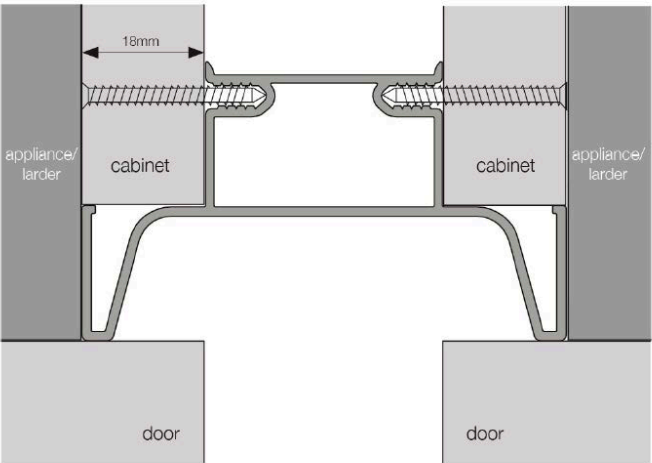

**Single Vertical Rail**

LARDER-SINGLERAIL is supplied in 4200mm lengths, ready for cutting down on site.

LARDER-SINGLE RAIL is fixed using 4 x 60mm screws [counter sunk.] It is best practice to position the screw holes in the cabinet so that they are concealed behind hinge plates when the internal components are added.

LARDER SINGLE RAIL requires a 35mm spacer between the two cabinets.

LARDER DOUBLE RAIL requires the cabinet gable ends to be reduced 20mm for installation behind the door; this is factory cut.



Spacer detail (back of unit)

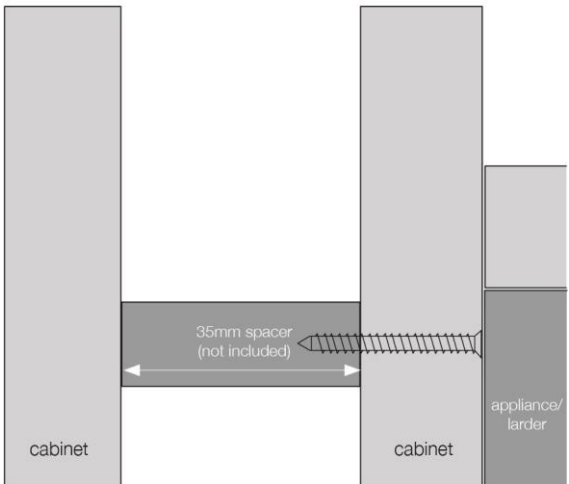

Rail profile

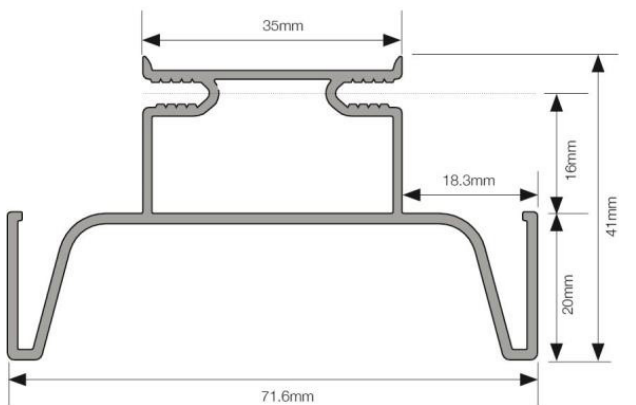



# Laminate Worktops

One major advantage of our high-pressure glued laminate worktops is that they are exceptionally easy to install and maintain. This leaflet is designed to provide you with all the information you require to install and care for your laminate worktop, and to help you keep it in pristine condition. We recommend taking the time to read through this leaflet before commencing installation, to ensure your worktop is fitted correctly.

Laminate worktops are supplied in shrink-wrap packaging. Please take care when removing and disposing of packaging, as edging strips are also enclosed. Do not discard any of the packaging supplied until you have checked all the parts, and please retain these instructions for future reference.

To ensure that the advertised size of the worktop is a completely usable section, laminate worktops may be supplied oversized in length by up to 50mm. Therefore, we recommend measuring the length of the laminate kitchen worktops prior to installation and trimming if required.

## DO NOT UNPACK WORKTOPS UNLESS:

- The room humidity is stable.
- All carcasses and cabinets are built and fully fitted/complete.
- All building dust and debris has been cleaned and cleared off site.
- All wet trades are finished and a sufficient period of time allowed for natural drying.
- Fresh plasterwork has been allowed to dry for a minimum of 6 weeks or until the plaster is dry throughout.

## Fixing:

When fixing laminate worktops to cabinets, position the fixings at even intervals - three screws at the back and front of each unit are recommended. Use a 4mm gauge drill bit to make clearance holes through the support panels on each cabinet. Place your laminate worktop on top of the cabinets, and check that it fits flush against the wall. Screw a 5mm x 35mm wood screw through each fixing position.

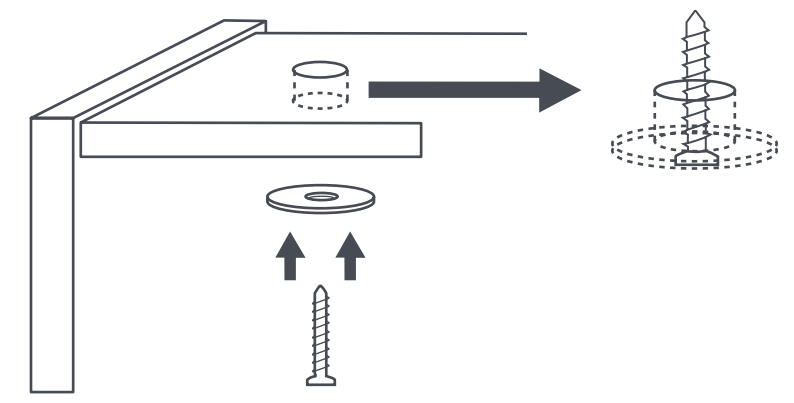

## Fixing to Masonry Features

Do not fix laminate worktops directly onto masonry. Use timber spacers measuring 6-10mm thick, with a Damp Proof Membrane (DPM) beneath. This prevents the transmission of moisture and provides airspace under the top, so that the composite fibreboard is not compromised.

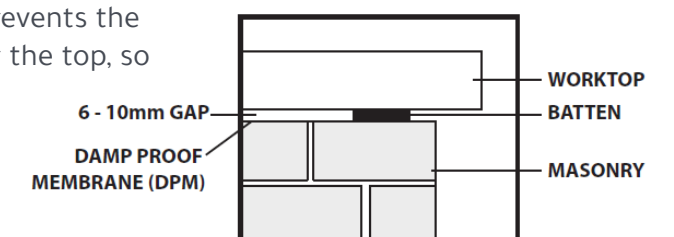



## Tiles

If you are fixing tiles above the work surface, be sure to leave a space of at least 3mm between the worktop and the bottom row of tiles. This will allow for easy removal of the worktop if necessary.

## Pipe Holes

If holes have been cut through the worktop to accommodate pipes, a 2-3mm allowance for expansion/contraction should be allowed around the pipe. This gap can be filled with a silicone sealant.

## Dishwashers and Washing Machines

When installing a dishwasher or washing machine, ensure that a protective moisture barrier is fitted correctly to the underside of the worktop. These are sometimes supplied by the appliance manufacturer or can be purchased directly from Worktop Express®.



## Edging Strips

Ensure that the cut edge of the worktop is flat and free from dust before attaching the matching edging strips, which are provided with all our laminate worktops. Edging can be attached by applying PVA adhesive - or an all-purpose contact adhesive such as Evo-Stik or Bostik - directly to the fibreboard edge. We strongly recommend covering the relevant areas of the decorative worktop surface with masking tape; this will protect the surface from any overspill of adhesive. If using PVA, the edging strip should be clamped in place while it dries.

Trim any excess from the edging strips (with a laminate trimmer or a sharp carpenter's plane) and use a fine-toothed file to smooth the edge until flush with the worktop.

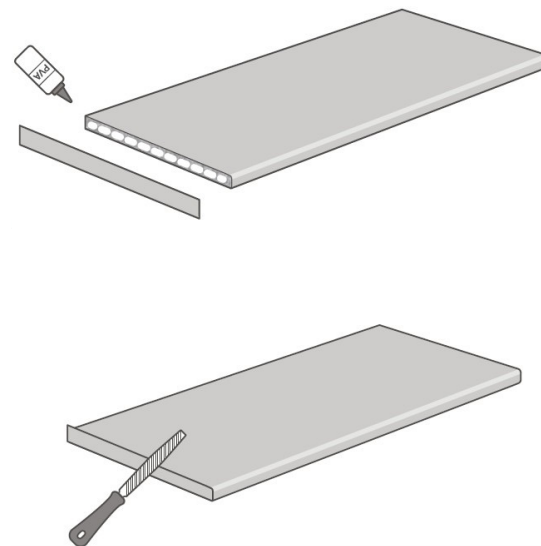

# Cutting Laminate Worktops

**IMPORTANT:** Before making any cuts into your worktop, double-check your measurements and ensure that these are marked correctly with a pencil.

## Cutting to Size

All cutting tools should be sharp, and safety goggles and a dust mask should be used whenever cutting laminated surfaces.

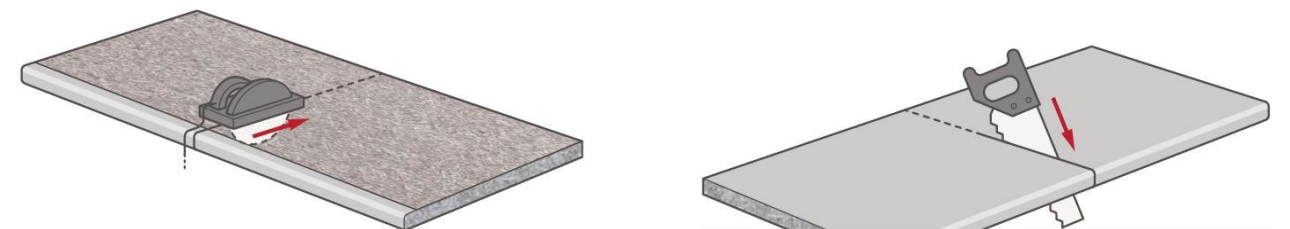

The best results will be achieved by cutting the worktop with a tolerance of +5mm, using a portable power saw (with the decorative side face down) or with a hand saw (decorative side face up). To finish the edge, use a portable hand router, straight edge and 'G' clamps. Clamp the straight edge to the worktop and ensure the cutter enters at the post-formed edge which will result in a perfectly straight, chip-free cut. Our staff can advise on a comprehensive range of professional-quality worktop jigs; please enquire for further information.

All cut edges must be sealed with a water-resistant material, such as silicone.

## Cut-outs for Hobs, Sinks etc.

When making a cut-out for a sink, hob or other inset worktop appliance, use the template supplied as a guide for cutting your worktop.

Any cut-outs should be carefully measured and marked. Working from the decorative surface, drill through all the corners using at least a 10mm diameter drill bit (sharp internal corners can lead to cracks forming in the laminate surface). Cut-outs can be made using a portable hand router, as explained above.

Alternatively, a jig saw can be used, providing that the four corners have been pre-drilled using a 10mm drill bit. Mark out the area to be cut on the decorative side of the worktop and drill a hole in each of the four corners of the cut-out. Then, turn the worktop over and mark a straight line from one hole to another. Use a jig saw with a fine-toothed blade to cut from hole to hole. Ensure the section to be cut out is well supported on the final cut.

Make sure that all exposed edges are sealed with a silicone sealant. If you have fitted an over mounted sink to the worktop, seal around the sink with an appropriate mould-resistant silicone, to prevent water ingress that will swell the fibreboard.

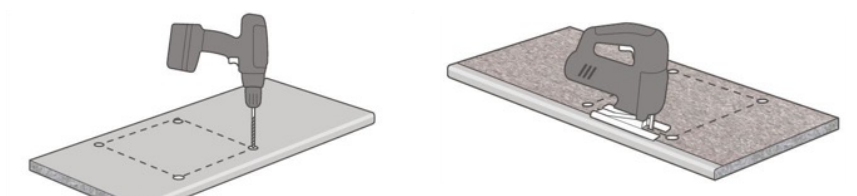

### Joining Worktops

When joining two laminate worktops together, we recommend using either a 90° standard joint or a 45° degree mitre joint depending on worktop layout. Bolt apertures should be cut on the underside of the worktop using a jig and should be no deeper than 25mm from the underside face. For a 600mm deep worktop three bolts are recommended, and four bolts for a 900mm deep worktop.

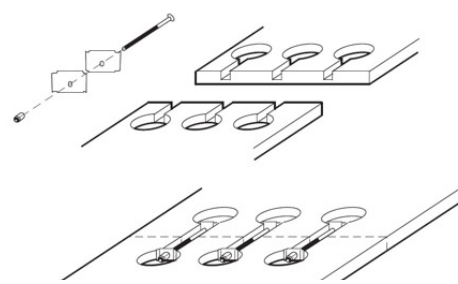

### Laminate Worktops Aftercare Instructions

Following a few easy steps will help keep your worktop in the best possible condition. Our recommendations are as follows:

#### Spillages

Be sure to mop up any spillages immediately with a clean dry cloth. Ensure no excess water is left around areas where there are cuts, joint or holes. Do not leave damp cloths, sponges or any other wet items on the top front edge of the worktop, as this area is more susceptible to water ingress.

#### Direct Cutting

Do not cut directly onto the worktop as this can result in scratches. Place a chopping board, butcher's block or worktop saver on top of the surface for this purpose. Please be aware that gloss worktops will show scratches, cuts and heat damage more prominently than a standard ma worktop.

#### Hot Cookware

Do not place hot pans or dishes directly onto the worktop. We recommend using a pan stand, or trivet, for this purpose.

#### Cleaning

General cleaning of the surface requires only a damp cloth and a mild detergent or non-abrasive cleaner diluted with warm water. Abrasive scouring powders, creams and polishes should be avoided. Potentially - persistent stains should be removed immediately. Buff the worktop after cleaning with a soft cloth.

#### Light Stains or Dirt

Clean with dry or damp paper towels, a cloth or a sponge.

#### Normal Stains or Dirt

e.g. fat, oil and dirt particles, finger-marks, lime deposits, rust, juice, coffee, tea, wax, blood, universal marker, etc. Clean with a cloth or soft nylon brush and washing-up liquid, soft soap, liquid soap or washing powder. If necessary, leave for a while and then rinse thoroughly with clean water.

#### Heavy Stains or Dirt

- e.g. discolouration through long exposure to tea, coffee, fruit juice, etc. Clean with washing powder and household bleach (but do not repeat too often).
- e.g. lead pencil, felt tip pens, marker and ball-point pens, lipstick, crayons, wax, shoe polish, nicotine, nail varnish. Clean with an organic solvent such as acetone (nail varnish remover), methylated spirits, petroleum spirit or perchloroethylene. Please read the manufacturer's instructions carefully!
- e.g. paint (water or solvent-based paints, two-component paints, spray paints), varnish stains, printing ink. Clean with water or organic solvent. Remove two-component paints immediately.
- e.g. adhesives (water-based, dispersion). Clean with water or an organic solvent.

### Egger Laminate Worktops 16mm Worktops Installation -

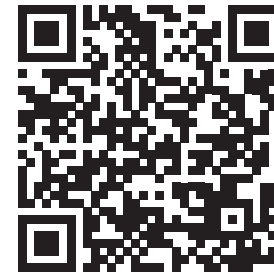

Scan/Click for the  
video tutorial

### Egger Laminate Worktops 25mm & 38mm Worktops Installation -



Scan/Click for the  
video tutorial



# Solid Wood Worktops

Wood is a natural product that can be affected by heat and humidity. It can gain and lose moisture before, during and after installation. For example, wood expands when it is warm, or the humidity level is high and contracts during colder periods or when the humidity level drops. When this occurs, it is possible for it to cause bowing or warping.

This leaflet is designed to give you all the information you require to install and care for your solid timber worktop in order for you to keep it in pristine condition. We suggest you spend a short time reading through this leaflet before you start, as some recommendations are required throughout the installation process.

Before your wooden worktops are installed, you must coat all surfaces with at least three layers of protective oil (the end grains will require more) - for DIY worktops we suggest using Rustins Danish Oil to achieve the best finish (if our pre-oiling service is utilised, Rustins Danish Oil is also recommended, but you only need to apply one coat AFTER installation and three coats to any newly-cut edges). After this, re-oil your worktop once a week for the first six weeks, and then every three months hereafter.

- Do not discard any of the packaging until you have checked all the parts.
- Please retain these instructions for future reference

## Storage

We recommend that all worktops are oiled immediately upon receipt. Installation should be carried out as soon as possible after delivery. However, if storage is necessary, after oiling the worktops must be laid flat and fully supported in their original packaging. Worktops must not be placed directly onto the floor, instead separate the floor and the worktop with battens as shown in the diagram below. Battens must also be used to separate multiple worktops stored together, also shown in the diagram below.

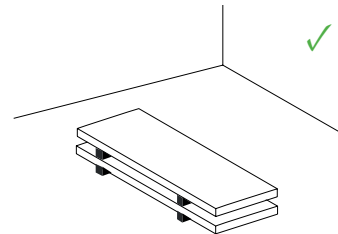

Make sure the storage area is indoors, has a stable humidity, and will not be subject to extremes of temperature.

## DO NOT UNPACK WORKTOPS UNLESS

- The room humidity is stable.
- All carcasses and cabinets are built and fully fitted/complete.
- All building dust and debris has been cleaned and cleared off site.
- All wet trades are finished, and a sufficient period of time allowed for natural drying.
- Fresh plasterwork has been allowed to dry for a minimum of 6 weeks or until the plaster is dry throughout.

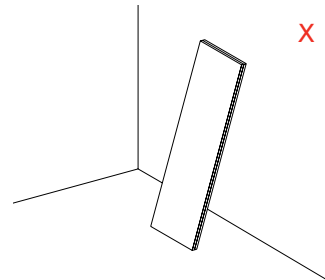

## Preparation:

Prior to placing the worktops in situ, it is important that you oil *all* the edges and faces at least three times with Danish Oil. Wipe away any surplus oil 30 minutes after application and allow between 6 and 8 hours between coats.

**NOTE:** Cut edges and areas of end grain will soak up more oil and will consequently require extra coats.

# Installation Precautions

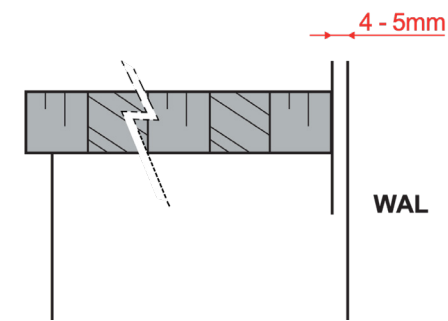

When positioning the worktop, you must allow a 4-5mm gap between all worktop edges and any adjacent walls or units (particularly between the back of the worktop and the wall). This will allow the worktop to expand and contract with the humidity of the kitchen without causing damage.

When a worktop is to be fitted near a free standing oven (i.e. an oven that is not housed in a cabinet, such as a range cooker) allow a minimum gap of 30mm all the way around the worktop, and fit a solid wood end cap along the worktop edge. This will protect the end grain and help to prevent splitting.

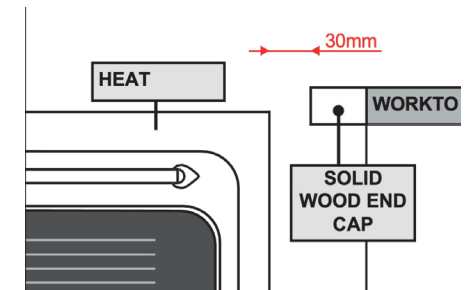

Special care must be taken when fitting a worktop over appliances or exposed brickwork. Appliances such as dishwashers, washing machines and microwaves can produce extremes of heat and humidity. If an appliance is to be installed under the worktop, make sure a moisture barrier is used to protect the underside from any possible heat or moisture. Use the same procedure for installations when you are fixing directly onto exposed brickwork.

**NOTE:** the maximum unsupported overhang that we recommend for a worktop is 200mm (based on a 620mm wide worktop). The recommendation for a larger overhang/span would be calculated on a pro-rata basis (i.e. the recommended unsupported overhang for a 960mm wide worktop [approx 55% larger than a 620mm wide worktop] would be 110mm). If you require a larger overhang, we may also suggest that a suitable support leg(s) is used.

# Fixing

When fixing worktops to the cabinets you must only use slotted angle brackets. A round head screw must be used to fix the bracket. It is important that you use the slot that runs perpendicular to the width (across and not parallel with the grain).

**NOTE:** Some cabinets are supplied with brackets that are not slotted and these must not be used.

If your cabinets have a solid top or you can only secure through the cross rail you will not be able to fit slotted brackets. In these circumstances you must drill an oversized hole (8-10mm) through the top of the carcass and secure the worktop using a larger washer and screw. This will allow the work surface to slide over the washer in case of any possible expansion or shrinkage.

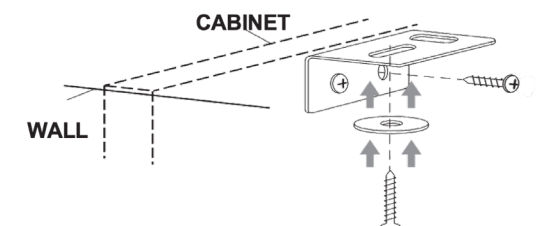

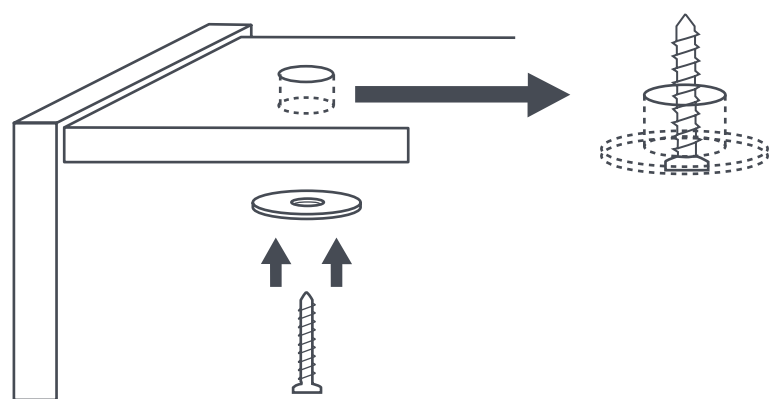

**IMPORTANT:** Do not screw through the carcass directly into the worktop. Do not use fixing blocks to secure. Do not use any worktop fixing methods other than those recommended here.

We recommend that worktops are fitted with an upstand where necessary to cover the 4-5mm expansion gap. The upstand must be fixed to the wall and NOT the worktop. The upstand will cover the gap and hide any possible shrinkage that may occur.

**NOTE:** An upstand is not required where tiling or silicone will cover the expansion gap.

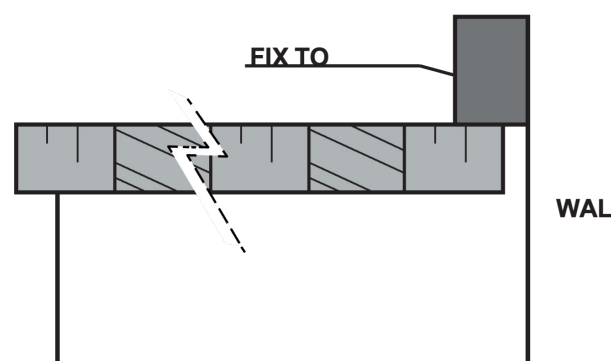

## Joining Worktops

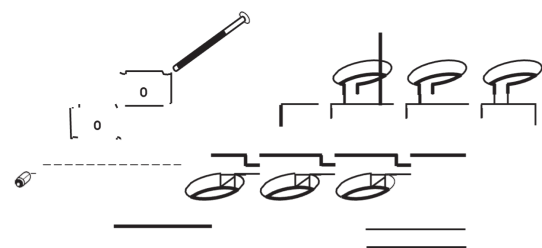

When joining two worktops together, you should use three standard worktop bolts on each joint. Seal the end grain at both sides of the joint with an appropriate sealer such as MitreSeal before making the joint. Seal the joint with sealer when the parts are finally tightened.

As a rule, only Butt joints should be used on wooden worktops. However, if your worktop has a radius and you do have to use a mitre joint, ensure that the "hockey stick" does not overextend the 10mm bull-nose radius.

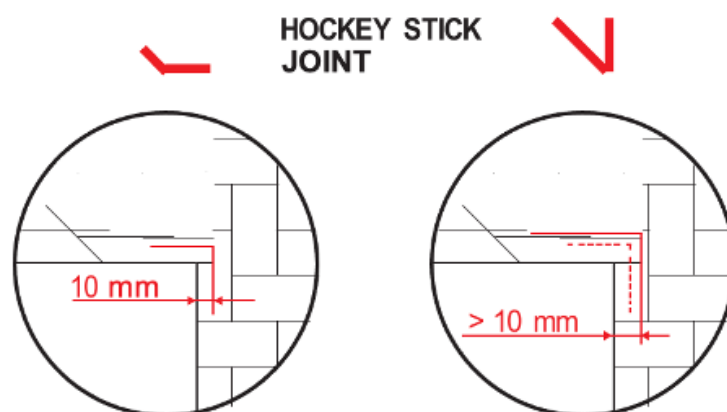
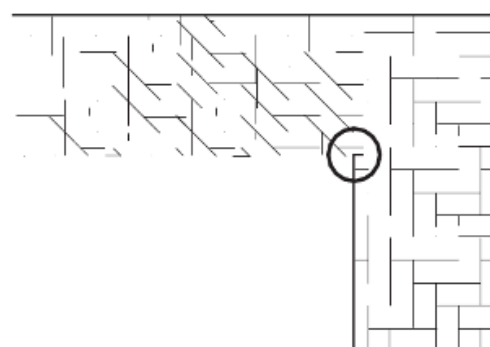
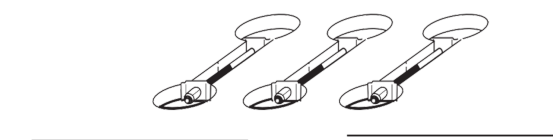

### Sealing Corner Joints

Make sure any end grain has been sealed before assembling the joints. Apply a light bead of clear low modulus silicone sealer along one side of the joint, just below the top surfaces and edges. Align the two sides with biscuits before clamping up firmly with worktop bolts. Wipe off any surplus sealant.

Move the tops into place. Use thin pieces of board as temporary packing to position them with 4-5mm expansion gaps between the edges and ends of the tops and the walls

### Finishing worktops

We recommend finishing our products with Rustins Danish Oil.

Make sure the wood surface is dry and clean. The face of the worktop requires 4-5 coats of oil to be applied to build up a barrier against water. Allow up to 6-8 hours between coats.

**NOTE:** Drying times will vary subject to room temperature.

After fitting and prior to applying the final coat of oil to the face, give the worktop a light sand with fine sandpaper, remove all dust then apply the coat of oil to the surface. Spread over the entire area and allow the oil to soak in for 30 minutes, always keeping the surface covered with oil. If some areas dry out, move the oil about or add more. After 30 minutes wipe off all excess to leave an even touch dry finish. Allow to dry overnight before repeating.

## Solid Worktop Aftercare Instructions

Following just a few simple rules will help you get the best out of your solid wood worktop. Our recommendations are as follows:

### Spillages

Be sure to mop up any spillages immediately with a clean dry cloth. Liquids should not be allowed to pool on the surface or stand for a length of time.

### Direct Cutting

Do not cut directly onto the worktop. Please place a chopping board or butcher's block on top of the worktop surface for this purpose.

### Direct Contact: Pots, Pans, and Other Items

Do not place hot, wet or dirty pots and pans straight onto the worktop. The worktop needs extra protection against such items; stainless steel hotrods are the perfect addition for this purpose and can be purchased alongside your worktop. In fact, most metal vessels (such as tin/aluminum cans, iron, copper, or steel containers) can stain the timber and as such contact between the two should be avoided.

### Cleaning

Wipe worktops down regularly with a damp (not wet), lint-free cloth, warm water, and a small amount of soap. We do not recommend using multi-purpose cleaning products which contain chemicals as this may damage the worktops. Please also avoid the use of scouring pads. If a scouring pad is used, the worktop may need to be re-oiled afterwards.

### Oiling

To maintain the fine quality of your solid wood worktop, be sure to oil regularly. Wood is a natural material, and a proper course of oil treatment is essential to ensure a long and trouble-free life.



In the first few weeks of use, special care must be taken to prevent the worktops becoming stained before they have built up sufficient oil protection. Water must not be allowed to lie on the surface.

When the surface has a sheen, and water “beads” or forms into droplets, you can tell that the worktop is in good condition. When the surface is dull and droplets don’t form, you need to re-oil the worktop. Ideally, you should re-oil the surface before it quite gets to that stage.

New worktops will require treating frequently to build up their protection. However, as the protective layer builds up they will gradually require oiling less often. The environment in which it is fitted and the amount of wear and tear a surface receives will affect how often a worktop needs oiling. However, we would recommend regular re-oiling at least every three months.



Scan/click here to view how to oil your wooden worktop.



Scan/click here for a video guide on how to punch a faucet hole in SiIGRANIT sink.

# Minerva and Metris Worktop Installation

Welcome to **minerva**®: the home of practical and solid kitchen worksurface material, manufactured using state-of-the-art technology.

Delivering a luxurious appearance, cool pleasing touch and robust performance day in, day out. With a 10-year guarantee against manufacturing defects, style is not compromised for quality.

Imperceptible, seamless joints with full design flexibility. Aspirations are a reality. Whether you dream of sweeping curves or contemporary lines, minerva® offers the flexibility to meet all your design needs.

We strongly advise that Minerva and Metris worktops are only fitted by competent and experienced acrylic solid surface professions. These are specialist worktops, and all our own fitters will have attended dedicated courses to work with this material. Please check that your fitting team has the capability to install this type of material to a high standard.

## Installation

The minerva® easy to fit system makes installation simple, and allows you to create worksurfaces to fit your own design requirements. Surfaces can be readily installed using standard woodworking equipment and they are supplied with pre-finished surfaces and edges. All this means is that there is no need for expensive and time-consuming templating usually associated with solid surface products.

Our unique jointing system can be used by kitchen fitters with conventional woodworking tools to achieve the seamless joint and edge for the complete ‘solid look’. minerva’s installation, care and maintenance manual provides all the information needed to fit and care for your minerva® worksurface.



Scan/click here to view the minerva® East Fit Installation Guide



[thekitchendepot.co.uk](http://thekitchendepot.co.uk)

